

Total Car parking no. - 311

NO	Size	Width	Level	Finish	Location
M1	1000x1000	1000	1.000	Tile Red	Basement
M2	1000x1000	1000	1.010	Tile Red	Basement
M3	1000x1000	1000	1.020	Tile Red	Basement

PROJECT  
**PROPOSED TOWNSHIP  
 "CALCUTTA RIVERSIDE" PROJECT  
 AT BATANAGAR, MOUZA - MIRPUR,  
 BANGLA, JAGTALA AND NANGI  
 WARD NO. 27 & 28  
 MAHESHTALA MUNICIPALITY,  
 SOUTH 24 PARGANAS**

FOR RIVERBANK DEVELOPERS PVT. LTD.

Parcel Name :

**HILAND GREENS II**  
 MOUZA - BANGLA, J.L. NO. - 41, KHATION NO. - 767  
 R.S. DAG NO. - 85(P), 94(P), 95(P), 96(P), 97(P), 98(P), 99(P), 100(P),  
 101(P), 102(P), 103(P), 104(P), 105(P), 106(P), 107(P), 108(P), 109(P),  
 110(P), 111(P) & 112(P)

Sub-Parcel Name :

**HILAND GREENS II**

Title :

**BASEMENT PLAN OF HILAND GREENS II**

Date **12.05.15** Drawing No.

Scale **1:200** CRS/HG-II/HG-II/BASEMENT/IGL-36

DRAWING STATUS - for MUNICIPAL SANCTION

NOTE:

ALL EXTERNAL & INTERNAL WALL ARE 250/200 THK. & 125/100 THK. BRICK WALL UNLESS STATED OTHERWISE. ALL DIMENSIONS ARE IN MM.

DECLARATION OF OWNER

THE CERTIFIED THAT I HAVE GONE THROUGH THE WEST BENGAL MUNICIPALITY (BUILDING) RULES, 2007, AND ALSO UNDERTAKE TO ABIDE BY THOSE RULES DURING AND AFTER CONSTRUCTION OF THE BUILDING.

Riverbank Developers Pvt. Ltd.  
*Sudhakar Dasgupta*  
 Authorized Signatory

SIGNATURE OF OWNER RIVERBANK DEVELOPERS PVT. LTD.

CERTIFICATE OF STRUCTURAL STABILITY

WE HEREBY CERTIFY THAT THE FOUNDATION AND SUPER STRUCTURE OF THE BUILDING PROPOSED FOR CONSTRUCTION ON THE HOLDING NO-1, NEW BATA ROAD, MOUZA - MIRPUR, JAGTALA, BANGLA & NANGI, WARD NO - 27 & 28, MAHESHTALA MUNICIPALITY HAVE BEEN SO DESIGNED BY ME/US WILL MAKE SUCH FOUNDATION AND SUPER STRUCTURE SAFE IN ALL RESPECT INCLUDING THE CONSIDERATION OF BEARING CAPACITY AND SETTLEMENT OF SOIL ETC.

*Pallabi Gupta Roy*  
 PALLABI GUPTA ROY  
 Registered Architect  
 Regn. No. - CA/65/18558

SIGNATURE OF ARCHITECT NAME, ADDRESS & EMPANELMENT NO.

*Upal Santra*  
 UPAL SANTRA  
 B.C.E., M.C.E. (STRUCT.)  
 M.E. - 54122/18/4  
 M.C. (Registered Structural Engineer)  
 Class I, E.S.E. No. 159

SIGNATURE OF STRUCTURAL ENGINEER NAME, ADDRESS & EMPANELMENT NO.

*Alak Roy*  
 ALAK ROY  
 Enlisted Geotechnical Engineer  
 Rajpur - Sonarpur Municipality  
 No. - 008/G.T. Eng.

SIGNATURE OF GEO-TECHNICAL ENGINEER NAME, ADDRESS & EMPANELMENT NO.

ARCHITECTURAL CONSULTANTS  
**MASTERS DESIGN STUDIO**  
 MASTERS MANAGEMENT CONSULTANTS  
 GA-142, 1444, RAJDANGA MAIN ROAD  
 KOLKATA 700107

STRUCTURAL CONSULTANTS  
**M.N. Consultants (Pvt.) Ltd.**  
 MNC House  
 1516, RAJDANGA MAIN ROAD  
 KOLKATA - 700107  
 Phone No. - (033) 4016 5712

GEO-TECHNICAL CONSULTANTS  
**Geotest Engineers Pvt. Ltd.**  
 (An ISO9001:2000 Certified Company)  
 Soil Investigations & Foundation Consultants BA, Milan Park,  
 Kolkata- 700054  
 Phone No. - (033) 2430 3494 / 8103

**RIVER BANK DEVELOPERS PVT. LTD.**  
 225 C, A.J.C. Bose Road, 4th Floor  
 Kolkata - 700020  
 Phone No. - (033) 2283 9015-17  
 Fax No. 91-33-2289 2148  
 W www.hilandcal.com

THIS DRAWING IS A PRIVATE AND CONFIDENTIAL DOCUMENT AND THE PROPERTY OF RIVERBANK DEVELOPERS PVT. LTD. IT MUST NOT BE COPIED OR LENT WITHOUT THE CONSENT OF RIVERBANK DEVELOPERS PVT. LTD.

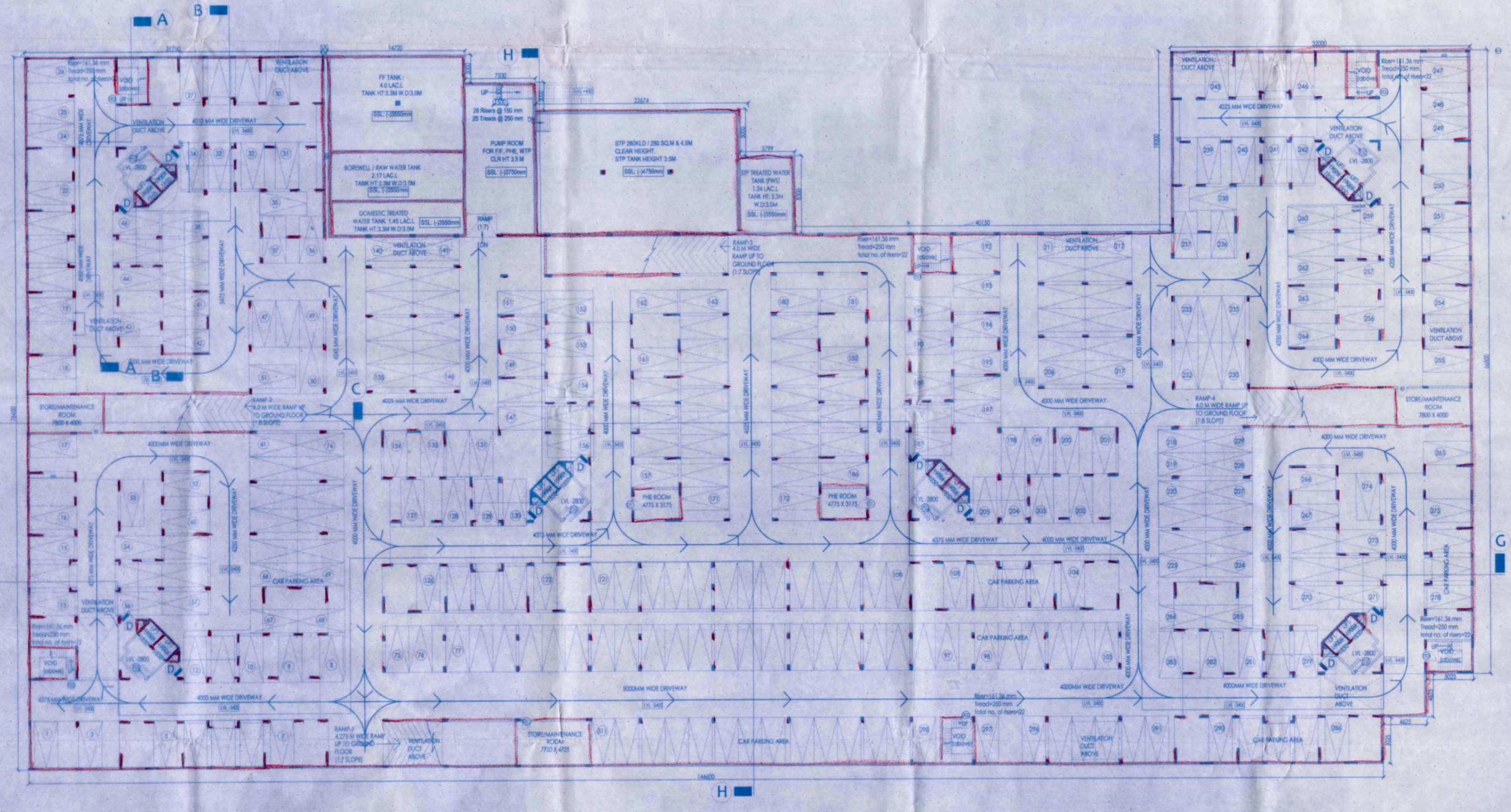

01/06/15  
Assistant Architect, East Circle,  
Municipal Engineering Directorate  
Govt. of West Bengal

08-08-2015  
Superintending Engineer, East Circle,  
Municipal Engineering Directorate  
Govt. of West Bengal



Construction should be made strictly according to sanctioned plan  
Date: 01/06/15  
Valid upto: 01/06/15  
Date of completion: 01/06/15  
The validity of this sanction is subject to the fulfillment of the conditions as mentioned in the sanctioned plan.

Member  
Municipal Engineering Directorate  
Govt. of West Bengal

578/06  
Ramesh Chandra Ghosh (P) Ltd  
27.08.08

ORIGINAL COPY / DUPLICATE COPY  
DEMOLITION  
PROVISIONALLY SANCTIONED  
APARTMENT BUILDING  
This form of sanction should be used for the sanction of demolition of buildings and private premises.

APARTMENT BUILDING

Sub Asstt. Engineer  
Municipal Engineering Directorate  
Maheshwari Municipality  
CIC Member  
Social Welfare  
1 JUL 2015

TIME EXTENDED  
Date: 01/06/15  
Valid upto: 01/06/15  
Construction should be made strictly according to sanctioned plan.

Plan No. 578/06  
Date 01/06/15  
Name Ramesh Chandra Ghosh (P) Ltd  
And 27.08.08  
Hand No. 01/06/15

RENEWAL