

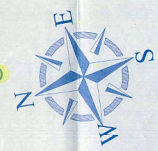

156 / 2, ACHARYA PRAFULLA CHANDRA ROAD / HARI SAHA MKT.



TWO STORIED BUILDING 11200

SPLAYED CORNER GIFTED TO KMC AREA = 2.88 SQM.

12987

PASSAGE

13643

5418 3107 4354

642 530 747

1431 7991

16326

15363

18105

RT SHED 11512 5769

302

17625 area of gift portion 12.35 sqm. 16076 area of gift portion 12.35 sqm. 2.895 MT WIDE PASSAGE

840 1036 2441

RTS

7831

11476

17099

THREE STORIED BUILDING PRES NO.7. MONMOHAN BOSE ROAD

15239 13671000 5000 MM WIDE SHRI ARABINDA SARANI 33847

ENTRY / EXIT 5000 MM X 6000 MM

2400

17380 14928

SPLAYED CORNER GIFTED TO KMC AREA = 2.88 SQM.

62676

KMC ROAD (MANMOHAN BOSE STREET)

ENTRY / EXIT 5000 MM X 6000 MM

32036

9143

BASEMENT PLAN SCALE: 1:100

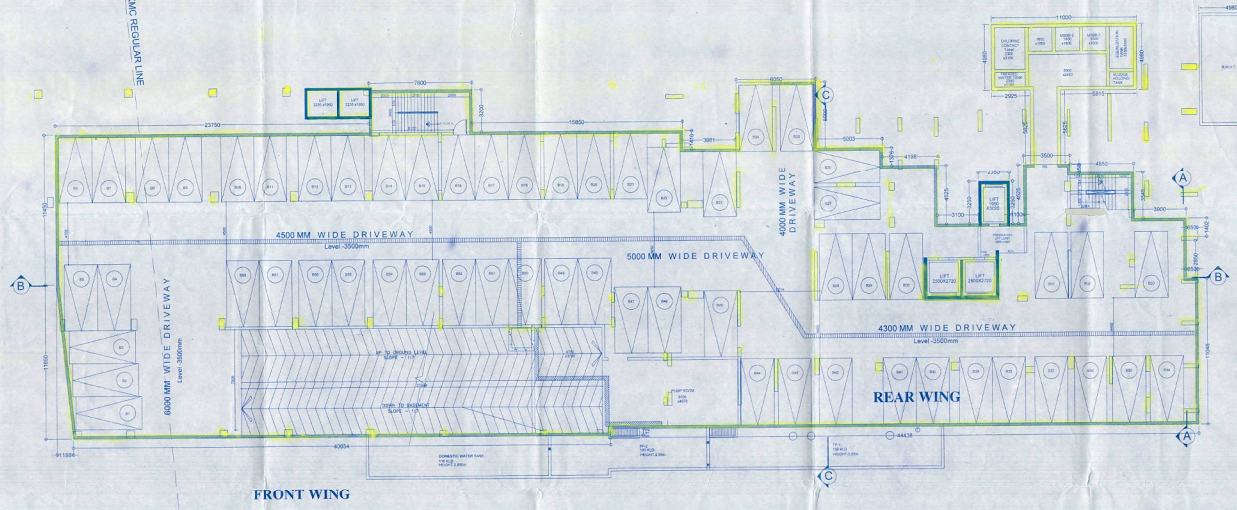

Signature of owner:

Signature of Structural Engineer:

Signature of Architect:

PROJECT: PLAN FOR PROPOSED ADDITIONAL 3 FL. LOOS OVER SANCTIONED REAR RESIDENTIAL WING BLDG. ALONG WITH SANCTIONED 4-5 STORIED REAR WING A PREMISES NO. 152 SHRI ARABINDA SARANI, KOLKATA - 700 066, WARD NO. 11, HOSE CIRCLE, WEST BENGAL SANCTIONED PLAN NO. 38300000, PLAT 27/2/11, AGAIN REGULARIZED U/R 26, 28/20 OF KMC BUILDING RULE 2008 ON DATED 28.08.2011, FLOOR AREA 1.46 HEZD. U/R 26/28 OF KMC BUILDING RULE 2008 ON DATED 28.08.2011, UNDER KOLKATA MUNICIPAL CORPORATION.

TITLE: BASEMENT PLAN

DATE: 24.05.2018

SANON SEN & ASSOCIATES (P) LTD.

15, HOSUR STREET, KOLKATA - 700 016

PHONE: 222 22478, 222 22884, 222 22885

FAX: 2222 9517 www.sanon.com