

GROUND FLOOR PLAN(PHASE-II)
SCALE: 1 : 200

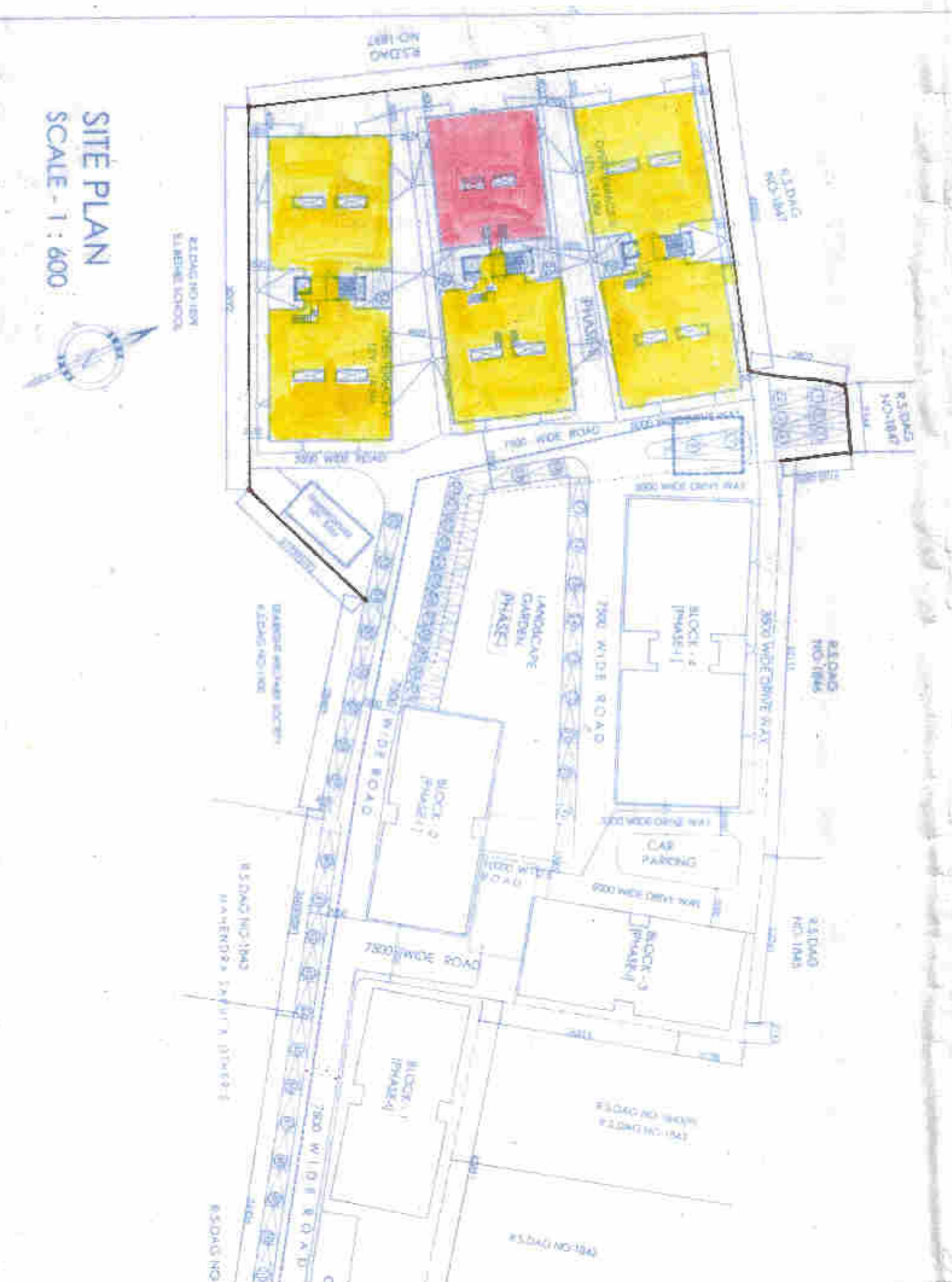

SITE PLAN
SCALE: 1 : 500



LOCATION PLAN
SCALE: 1 : 3000

Block No.	Block Name	Area (sq. m)	No. of Flats	Total Area (sq. m)	Total No. of Flats
1	Block-1	1212.42	42	1212.42	42
2	Block-2	1312.54	45	1312.54	45
3	Block-3	1312.54	45	1312.54	45
4	Block-4	1312.54	45	1312.54	45
Total		5150.04	177	5150.04	177

CERTIFICATE OF ARCHITECT

SIGNATURE OF ARCHITECT

CERTIFICATE OF STRUCTURAL ENGINEER

SIGNATURE OF STRUCTURAL ENGINEER

SIGNATURE OF OWNER

CERTIFICATE OF ADDITIONAL ALTERATION

SIGNATURE OF ARCHITECT

CLIENT: SWANWASTUNG INFRA PVT. LTD. / BENGAL ECO HOUSING PVT. LTD. / 97A, SOUTHERN AVENUE, KOLKATA - 700029.

PROJECT: PROPOSED ADDITION ALTERATION OF RESIDENTIAL COMPLEX AT-MOUZA-RASAPUNJA, JL.NO-15, R.S.NO-92, KHATAN NO.- 4416, 4475, 4476, 4477, 4478, 4479, 4480, 4481, 4482, 4483, 4484, 4485, 4486, 4487, 4488, 4489, 4490, 4491, 4492, 4493, 4494, 4495 & 4496. R.S.DAG NOS- 1898, L.R.DAG NOS- 1309(P), P.S-BISHNUPUR, DIST-24 (PGS/SOUTH), UNDER-RASAPUNJA G.P.

ARCHITECT: AAIN DESIGN STUDIO

DATE: 20/12/2023

SCALE: 1:200

DRG. NO.: -SD-RSP-ILA01