

SITE PLAN AT HOLDING NO. 513 PAKPURA ROAD P.S. NO. 147, R.S. DIST. NO. 2205/2202
 2206/2204/2206/2207/2207 UNDER P.O. KHATAH NO. 2381, 2391 AND J.R. DIST. NO. 2200/2207/2204
 2209/2207/2206 UNDER L.R. KHATAH NO. 2376/2378/2384/2377/2380/2379/2375/2377/2378/2379
 2204/2200/2200/2201/2202/2203/2204/2205/2206/2208/2207/2208
 P.L. NO. 36, J.L. NO. 36, WARD NO. 26,
 TALUKA - LAKHNA PAKPURA, P.S. - SONARPUR, DIST. - MPDS (B), UNDER RAJPUT SONARPUR
 MUNICIPALITY
 AREA OF PLOT AS PER ORIGINALLY = 411.87 SQ. METR.
 AREA OF LAND AS PER PHYSICAL = 410.728 SQ. METR. (1.14% DIFF)
 NET LAND AREA OF LAND AS PER PHYSICAL = 410.728 SQ. METR. (1.14% DIFF)
 BOUNDARY DEMONSTRATED BY BLACK BORDER
 SCALE: 1:500

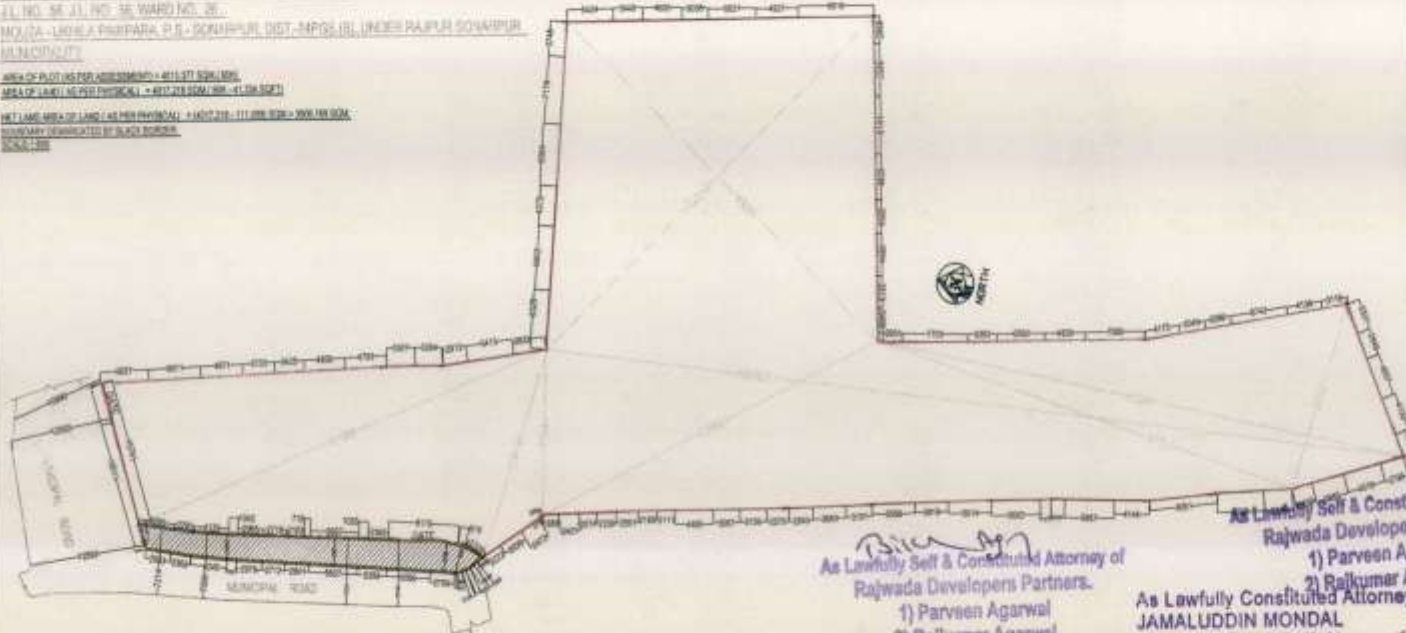

As Lawfully Self & Constituted Attorney of
 Rajwada Developers Partners.

- 1) Parveen Agarwal
- 2) Rajkumar Agarwal

As Lawfully Constituted Attorney of

AKLIMA MONDAL
 RAHATULLA MONDAL
 NAZRUL MONDAL
 NURNEHAR BIBI SARDAR
 NURJABAN MONDAL
 SAHBUDDIN MONDAL
 NURUDDIN MONDAL
 AMINUDDIN MONDAL
 EASHAK ALL MONDAL

As Lawfully Self & Constituted Attorney of
 Rajwada Developers Partners.

- 1) Parveen Agarwal
- 2) Rajkumar Agarwal

As Lawfully Constituted Attorney of

JAMALUDDIN MONDAL
 KAMALUDDIN MONDAL
 SAMAUDDIN MONDAL
 SALAUDDIN MONDAL
 MAHAMUDA BIBI
 MAJIDA MONDAL
 EKIDA SEKH
 RASIDA BIBI
 ASHIDA GAZI
 SAJIDA KAZI
 KESHIDA BIBI SEKH

SIGNATURE OF OWNERS