

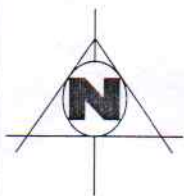

SKETCH MAP OF SHYAM SUNDAR DAS AT MOUZA -  
BASUDEVPUR . J.L. NO - 126, ON PLOT NO - 1408  
(Part), P. S.- DURGACHAK, DIST - PURBA MEDINIPUR.



AREA OF LAND - 0.04083 ACRE .

(SCALE- 1 : 1000)



ALL DIMENSION ARE IN LIKS.  
CONVERSION LAND SHOWING THUS -   
PLOT NUMBER'S ENGLISH LETTER  
PLOT NO - 1408 (Part).  
AREA OF LAND - 0.04083 ACRE.

*Shyam Sundar Das*  
SIGN. OF OWNER'S

*Jug narayan sult*  
**SURVEYOR**  
**J. N. Shit**  
**Reg. No.-15823**  
**Mahisadal**  
**SURVEYOR SING.**

**SKETCH MAP OF KALPANA DAS AT MOUZA -  
BASUDEVPUR. J.L. NO - 126, ON PLOT NO - 1408 &  
 $\frac{1403}{4102}$ , P. S.- DURGACHAK, DIST - PURBA MEDINIPUR.**

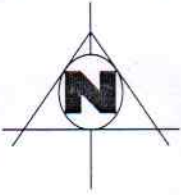

(SCALE- 1 : 1000)

AREA OF LAND - PLOT NO- 1408 - 0.14417 ACRE .

AREA OF LAND -  $\frac{1403}{4102}$  - 0.05665 ACRE .

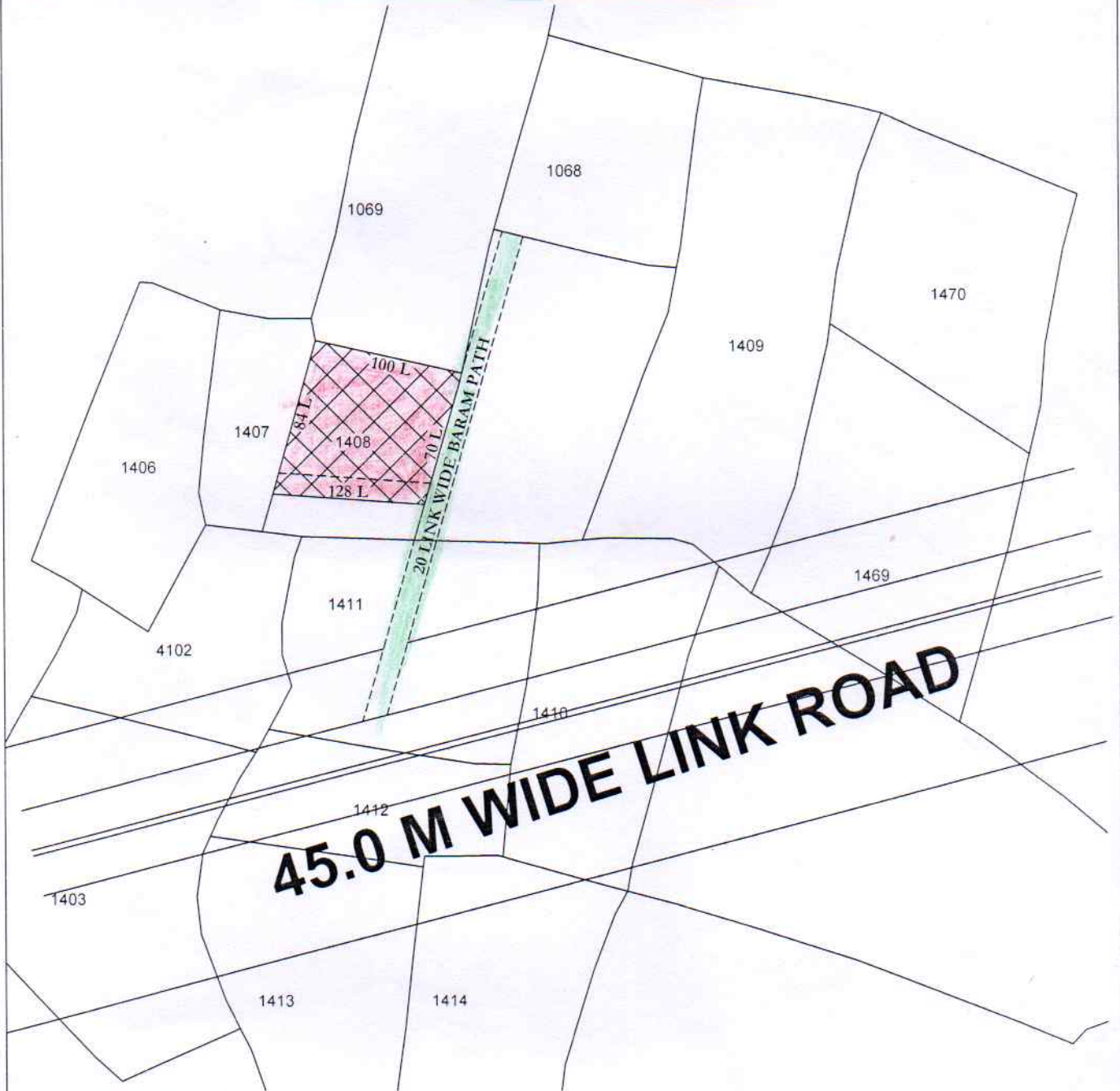

ALL DIMENSION ARE IN LIKS.

CONVERSION LAND SHOWING THUS -  PLOT NUMBER'S ENGLISH LETTER

PLOT NO - 1408 (Part) &  $\frac{1403}{4102}$ .

AREA OF LAND - 0.14417 ACRE + 0.05665 ACRE.

TOTAL AREA OF LAND - 0.14417 ACRE + 0.05665 ACRE. = 0.20082 ACRE.

SIGN. OF OWNER'S  
KALPANA DAS

*Jay narayan Sait*  
SURVEYOR  
J. N. Sait  
Reg. No.-15823  
Mahisadal  
SURVEYOR SING.



Dist.- Purba Medinipur  
 P.S.- Durgachak  
 Mouza-BASUDEVPUR, Sheet No.-1  
 J.L. No.- 126  
 The Hand Sketch Map is not to Scale  
 Measurement is in link

*✓* *Barabari Bazar*

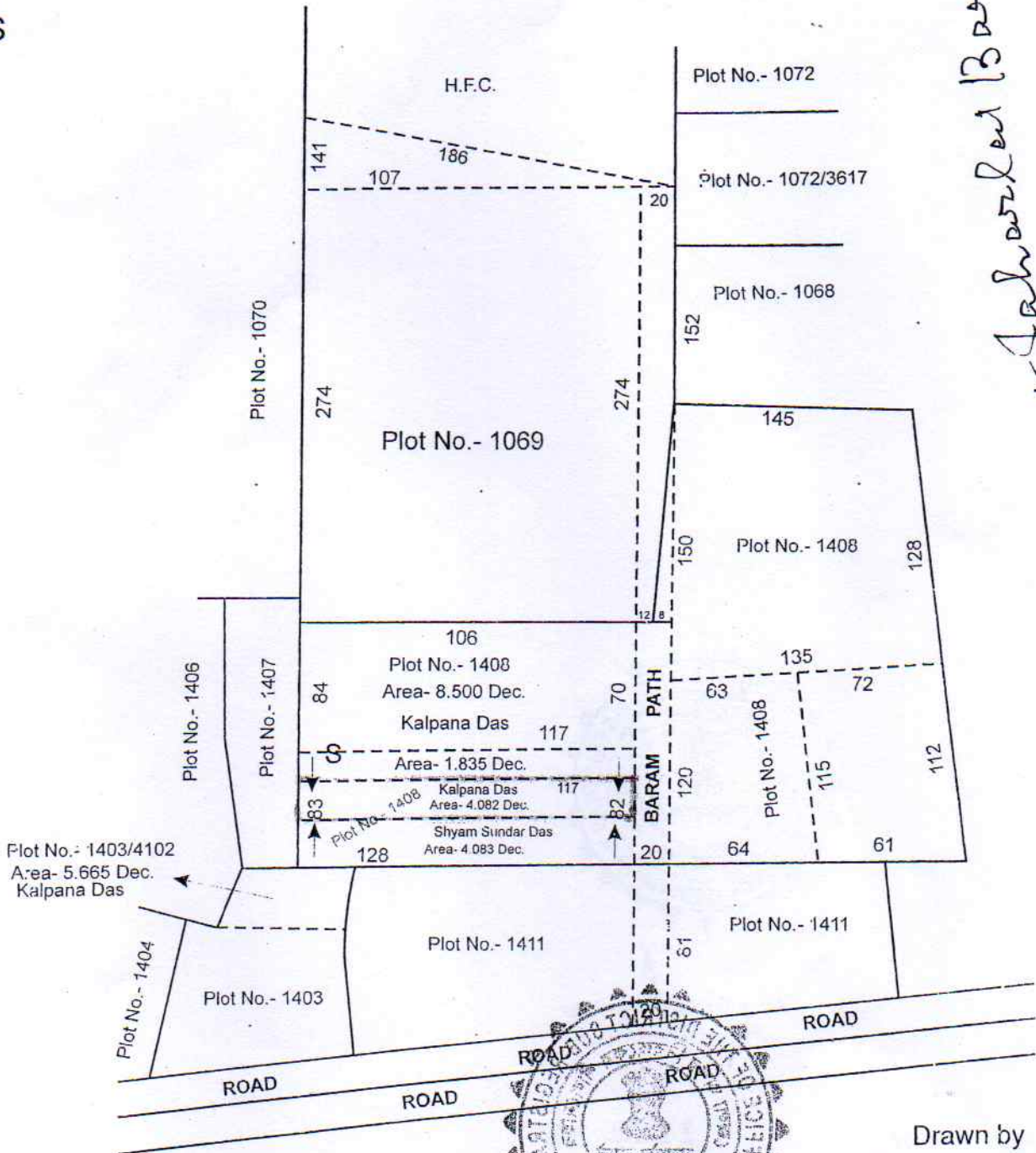

**Simple Reference**

Purchasers' Name - **Kalpana Das**  
 Sale Plot No.-1408  
 Sold Area- 4.082 Dec.  
 Sale Plot marked with Red Boundary.  
 Barampath marked with Yellow Colour.



District Sub-Registrar  
 Purba Medinipur  
 Tamrunk

Drawn by

*Swapan Kumar Maity*

**Swapan Kumar Maity**  
 Licence No.- 181/1993  
 Vill. & P.O.- Barabari  
 P.S.- Bhabanipur  
 Dist.- Purba Medinipur  
 Date .- 23-06-2014

1 a DEC 2014

Dist.- Purba Medinipur  
P.S.- Durgachak  
Mouza- BASUDEVPUR, Sheet No.- 1  
J.L. No.- 126  
The Hand Sketch Map is not to Scale  
Measurement is in link

S

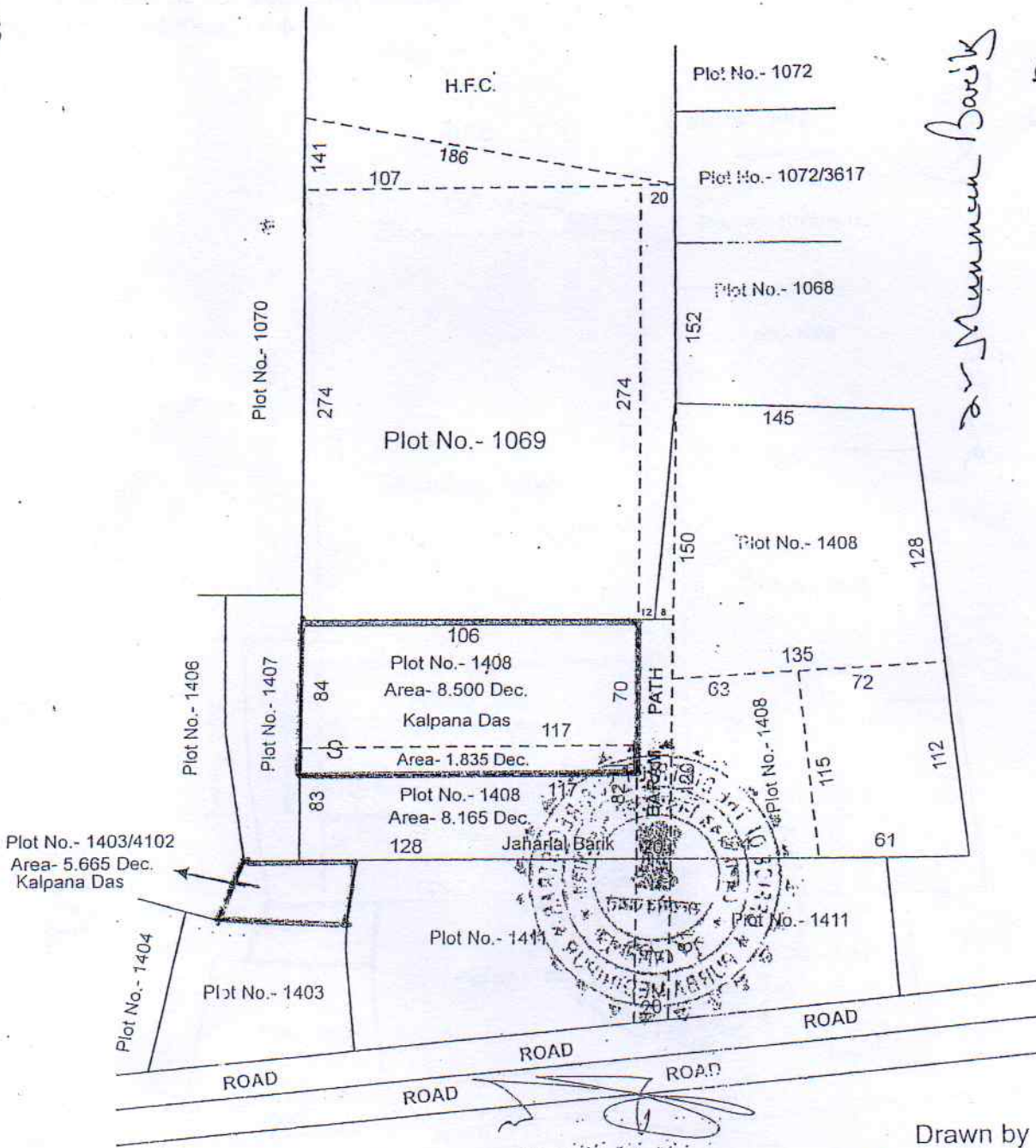

Dr. Munmun Barik  
Dr. Jaharalal Barik

**Simple Reference**

Purchasers' Name - Kalpana Das

Sale Plot No.-1408

Sold Area- 10.335 Dec.

Sale Plot.No.-1403/4102

Sold Area- 5.665 Dec.

Total Sold Area- 16.000 Dec.

Sale Plot marked with Red Boundary. 

Barampath marked with Yellow Colour.

Handwritten signature and stamp of the surveyor.

Drawn by

*Swapan Kumar Maity*

**Swapan Kumar Maity**

Licence No.- 181/1993

Vill. & P.O.- Barabari

P.S.- Bhabanipur

Dist.- Purba Medinipur

Date .- 23-06-2014

Dist.- Purba Medinipur  
 P.S.- Durgachak  
 Mouza-BASUDEVPUR, Sheet No.-1  
 J.L. No.- 126  
 The Hand Sketch Map is not to Scale  
 Measurement is in link

*✓ Jankar Lal Barua*

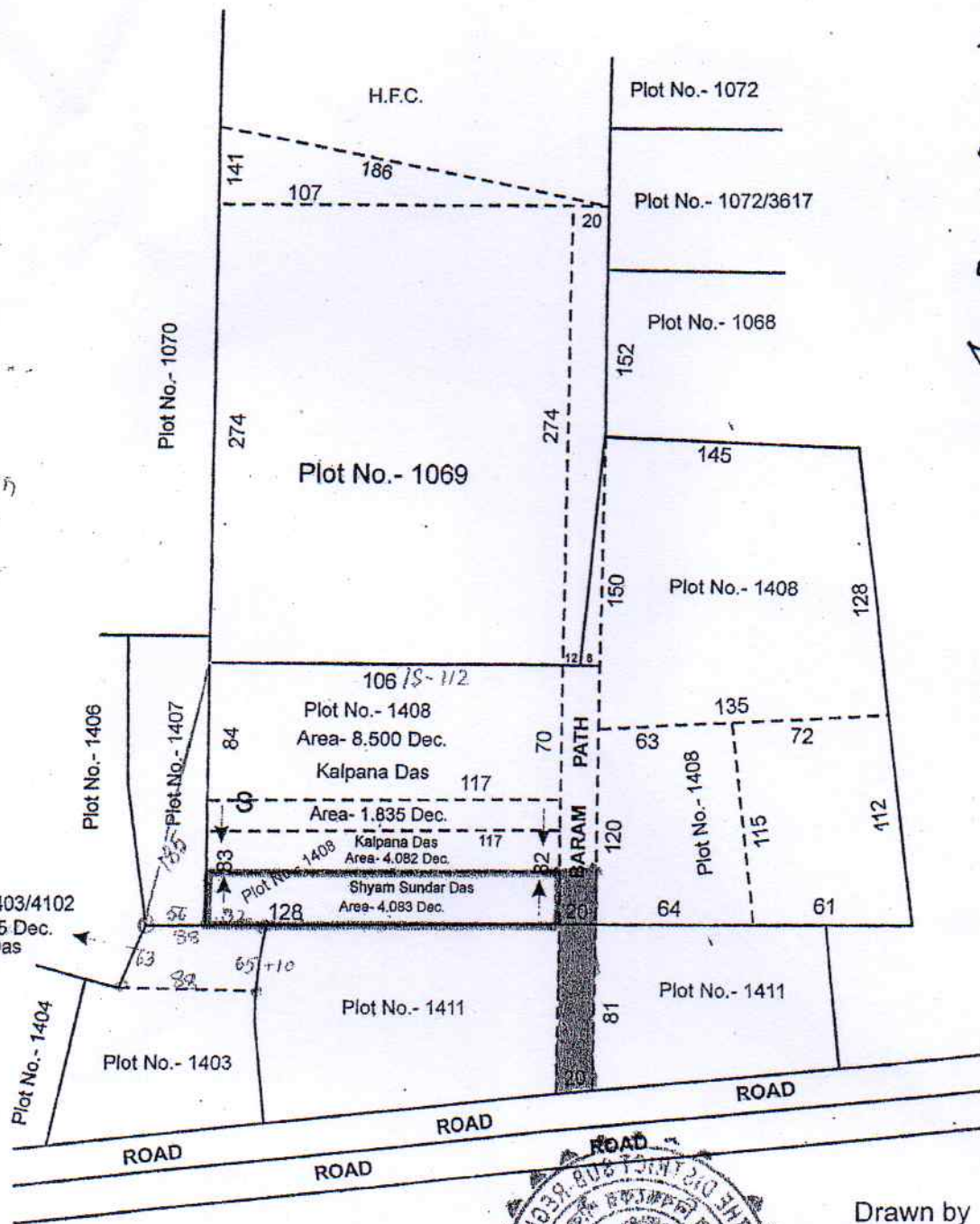

*117 x 153 v 5*  
*1408/4102*  
*5*

**Simple Reference**  
 Purchasers' Name - Shyam Sundar Das  
 Plot No.-1408  
 Old Area- 4.083 Dec.  
 Plot marked with Red Boundary.  
 Rampath marked with Yellow Colour.



Drawn by  
*Swapan Kumar Maity*  
**Swapan Kumar Maity**  
 Licence No.- 181/1993  
 Vill. & P.O.- Barabari  
 P.S.- Bhabanipur  
 Dist.- Purba Medinipur  
 Date .- 23-06-2014

*Swapan Kumar Maity*  
 District Sub-Registrar  
 Purba Medinipur  
 Tamaluk

19 DEC 2014