

- SPECIFICATIONS :**
- ALL DIMENSIONS ARE IN MILLIMETERS UNLESS OTHERWISE STATED.
 - ALL EXTERNAL WALLS ARE 250/200 THK & ALL INTERNAL WALLS ARE 100 THK & 75 THK.
 - THE DEPTH OF U.G.W.A. & SEPTIC TANK SHALL NEVER EXCEED THE DEPTH OF FOUNDATION.
 - BRICK WORK 250/200 THK WITH MORTAR 1:6 & BRICK WORK 100 THK & 75 THK WITH MORTAR 1:4 MIX.
 - ALL CONCRETE OF R.C.C. WORKS AS SPECIFIED BY STRUCTURAL ENGINEER.
 - GRADE OF STEEL AS SPECIFIED BY THE STRUCTURAL ENGINEER.
 - ALL SORTS OF PRECAUTIONARY MEASURES WILL BE TAKEN AT THE TIME OF CONSTRUCTION.
 - OTHER ITEMS ARE AS PER I.S. SPECIFICATION.
 - THIS DRAWING SHALL BE READ IN CONJUNCTION WITH ALL OTHER RELEVANT DRAWINGS.

THE STRUCTURAL DESIGN & DRAWING OF BOTH FOUNDATION & SUPERSTRUCTURE OF THE BUILDING AT PREMISES NO. - 354, PRANTIK PALLY, KOLKATA, HAVE BEEN MADE BY ME CONSIDERING ALL THE POSSIBLE LOADS INCLUDING SEISMIC LOAD AS PER THE NATIONAL BUILDING CODE OF INDIA & CERTIFIED THAT IT IS SAFE & STABLE IN ALL RESPECT. SOIL TESTING REPORT HAS BEEN DONE BY ALOK ROY OF HIS GEOTECH ENGINEERS PVT. LTD. THE RECOMMENDATION OF SOIL TEST REPORT HAS BEEN CONSIDERED DURING STRUCTURAL CALCULATION.

NAME OF STRUCTURAL ENGINEER.
SUMITA DEY (ESE/1/93)

I HAVE REVIEWED / CHECKED THE STRUCTURAL DRAWING AND DESIGN DETAILS OF THIS PROJECT WHICH HAS BEEN DONE COMPLYING RELEVANT I.S. CODE INCLUDING SEISMIC AND THE NATIONAL BUILDING CODE.
I CERTIFY THAT THE STRUCTURE WILL BE SAFE & STABLE AGAINST ALL VERTICAL AND LATERAL LOADS AND WILL BE FIT FOR HABITABLE USE.

NAME OF STRUCTURAL REVIEWER.
SANJIV J PAREKH (104/13 KMC)

UNDERSIGNED HAS INSPECTED THE SITE AND CARRIED OUT SOIL INVESTIGATION THEREON IT IS CERTIFIED THAT THE EXISTING SOIL OF THE SITE IS ABLE TO CARRY THE LOAD COMING FROM THE PROPOSED CONSTRUCTION AND THE FOUNDATION SYSTEM PROPOSED HEREIN IS SAFE & STABLE IN ALL RESPECT FROM GEO-TECHNICAL POINT OF VIEW.

NAME OF GEO - TECHNICAL ENGINEER.
ALOK ROY (G.T./I/1)

I / WE DO HEREBY DECLARE WITH FULL RESPONSIBILITY THAT, I / WE SHALL ENGAGE ARCHITECT & E.S.E DURING CONSTRUCTION. I / WE SHALL FOLLOW THE INSTRUCTIONS OF ARCHITECT AND E.S.E DURING CONSTRUCTION OF THE BUILDING (AS PER B.S PLAN) K.M.C AUTHORITY WILL NOT BE RESPONSIBLE FOR STRUCTURAL STABILITY OF THE BUILDING AND ADJOINING STRUCTURES. IF ANY SUBMITTED DOCUMENTS ARE FOUND TO BE FAKE, THE K.M.C AUTHORITY WILL REVOKE THE SANCTION PLAN. THE CHARACTER OF LAND IS BATHULI. THE CONSTRUCTION OF WATER RESERVOIR AND SEPTIC TANK WILL BE UNDERTAKEN UNDER THE GUIDANCE OF E.S.E / ARCHITECT. BEFORE STARTING OF BUILDING FOUNDATION WORK, DURING DEPARTMENTAL INSPECTION OF THE SITE THE PLOT IS IDENTIFIED BY ME.

NAME OF OWNER.
INDRANI GHOSH (DIRECTOR OF GLOBAL CARE HOSPITAL)

I CERTIFIED WITH FULL RESPONSIBILITY THAT THE BUILDING PLAN HAS BEEN DRAWN AS PER PROVISION OF K.M.C BUILDING RULES 2009 AS AMENDED FROM TIME TO TIME AND THE SITE CONDITION INCLUDING WIDTH TO THE ABUTTING ROAD (15.0 M.) CONFORMS WITH THE PLAN, WHICH HAS BEEN MEASURED & VERIFIED BY ME. IT IS A BUILDABLE SITE NOT A TANK OR FILLED UP TANK. THE LAND IS DEMARCATED BOUNDARY WALL. THE CONSTRUCTION OF U.G. WATER TANK AND SEPTIC TANK WILL BE COMPLETED BEFORE STARTING OF BUILDING FOUNDATION WORK. THE PLOT IS LOCATED 500 M. FROM C/L OF E.N.R.P.S.S.

NAME OF ARCHITECT.
SUBIR KUMAR BASU (CA/78/4375)

PROJECT TITLE :
PROPOSED (B+G+10) STORIED (35.80M) RESIDENTIAL BUILDING AND (B+G+6) STORIED (22.450 M.) INSTITUTIONAL BUILDING , AT PREMISES NO. 354, PRANTIK PALLY, KOLKATA-700042, WARD - 107, MOUZA- KASBA, JL NO.-13, U/S 393A OF KMC ACT 1980 & COMPLYING B/R 2009.

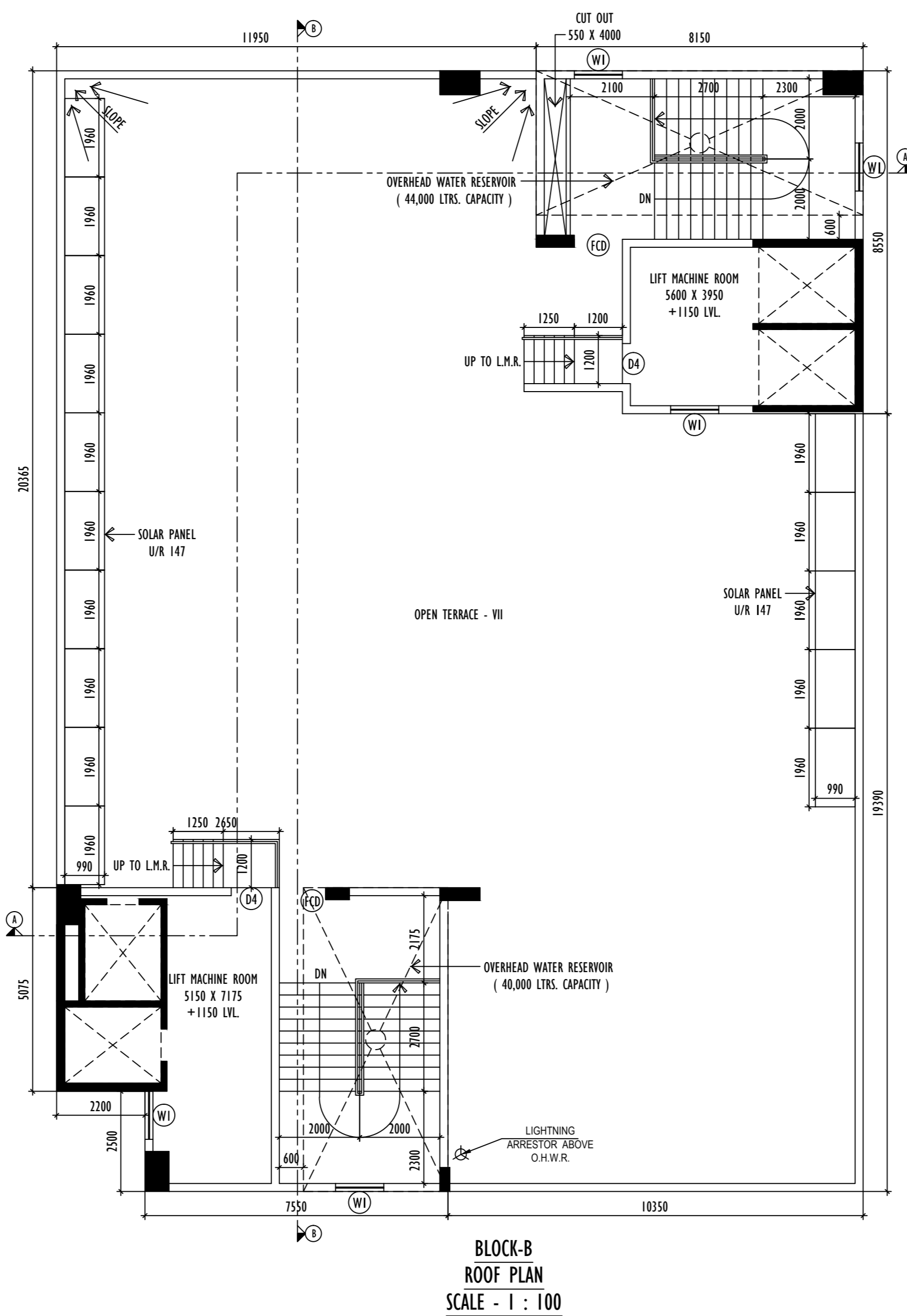
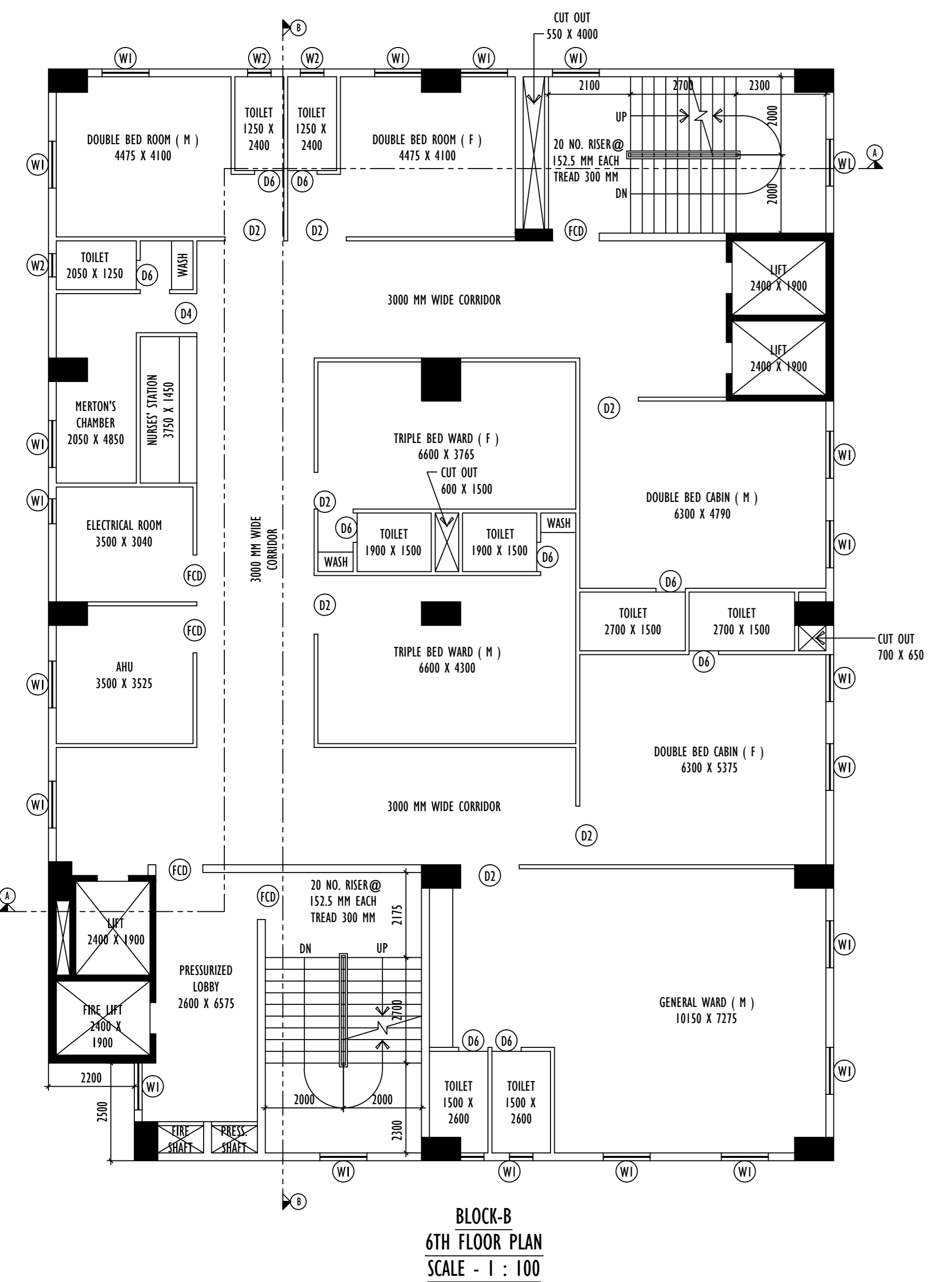

AREA CALCULATION (ALL AREA ARE IN SQMT.) :-

FLOOR	COVERED AREA	CUTOUT	STAIR WELL	LIFT WELL	EXEMPTED AREA STAIR & STAIR LOBBY	NET FLOOR AREA	GROSS FLOOR AREA
BASEMENT	556.094	-	-	-	55.680	6	494.414
GROUND	564.959	4.511	-	18.24	55.680	12.000	474.528
1ST	556.094	72.637	-	18.24	55.680	12.000	397.537
2ND	556.094	4.511	-	18.24	53.400	12.000	467.943
3RD	556.094	4.511	-	18.24	53.400	12.000	467.943
4TH	556.094	4.511	-	18.24	55.680	12.000	465.663
5TH	556.094	5.866	-	18.24	53.400	12.000	466.588
6TH	556.094	5.866	-	18.24	53.400	12.000	466.588
TOTAL =	4457.617	102.413	-	127.680	436.320	90.000	3701.204

2 : CAR PARKING CALCULATION : (BLOCK - B)

AT FLOOR	HOSPITAL GROSS FLOOR AREA	REQUIRED CAR PARKING
GROUND TO 7TH	4227.524	(TOTAL BUILT-UP AREA / 75) = (4227.524/75) = 56.36 OR 57
3. PROVIDED STAIR HEAD ROOM AREA :-		66.763
4. LIFT MACHINE ROOM AREA :-		62.641
5. OVER HEAD TANK AREA :-		56.610
6. LIFT MACHINE ROOM STAIR AREA :-		6.610
7. TERRACE AREA :-		556.094
8. SOLAR ENERGY SYSTEM :-		29.106
9. TOTAL EXEMPTED AREA :-		526.72
10. OTHER AREA ONLY FOR FEES = (EXEMPTED AREA + LIFT MACHINE ROOM STAIR AREA)		532.930

DOOR OPENING SCHEDULE

LEGEND	WIDTH	HEIGHT	LINTEL HT	SIL HT
D1	1800	2250	2250	---
D2	1500	2250	2250	---
D3	1200	2250	2250	---
D4	1000	2250	2250	---
D5	900	2250	2250	---
D6	750	2250	2250	---
D7	650	2250	2250	---
D8	1200	2125	2125	---
GD	3000	2250	2250	---
FCD	1200	2250	2250	---

WINDOW OPENING SCHEDULE

W1	1200	1800	2250	450
W2	600	900	2250	1350

B.P NO : 2027/20248
VALID UP TO : 09-AUG-27
SIGNATURE OF A.E. (C)

DATE : 10-AUG-22
SIGNATURE OF E.E. (C)

SHEET TITLE :
6TH TO ROOF PLAN, ELEVATION, SECTION - AA, SECTION - BB

ARCHITECT :
M/s. Subir Kumar Basu
Consulting Architects & Engineers
4, Broad Street, Kolkata - 700 019
website : www.subirkumarbasu.com

DRAWN BY : ARPAN ROY **DEALT BY :** DIPANGU SEKHAR BISWAS **CHECKED BY :** RAJA BASU **APPROVED BY :** SGB

SCALE - 1:100 **SHEET NO. - 10** **DATE - 24.04.2021**