

PROPOSED G+V STORIED RESIDENTIAL BUILDING PLAN OF JOYDEB BALA & BASUDEB BALA OF PREMISES NO.10, KABI BHARAT CHANDRA ROAD, FORMALLY-22/C, GORAKSHA BASI RPAD, AT MOUZA-SATGACHI, J.L. NO. 20, R.S. NO.154, TOUZI NO.182, L.R. KHJATIAN NO.5580, C.S. DAG NO.1197, R.S. DAG NO.3689, L.R. DAG NO.3710 IN WARD NO.-26, HOLDING NO.105, KABI BHARAT CHANDRA ROAD, P.S.-DUM DUM, DIST-24 PGS(N), UNDER SOUTH DUM DUM MUNICIPALITY.

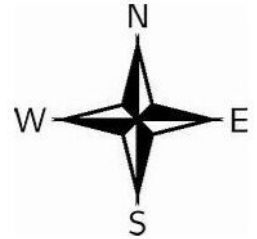
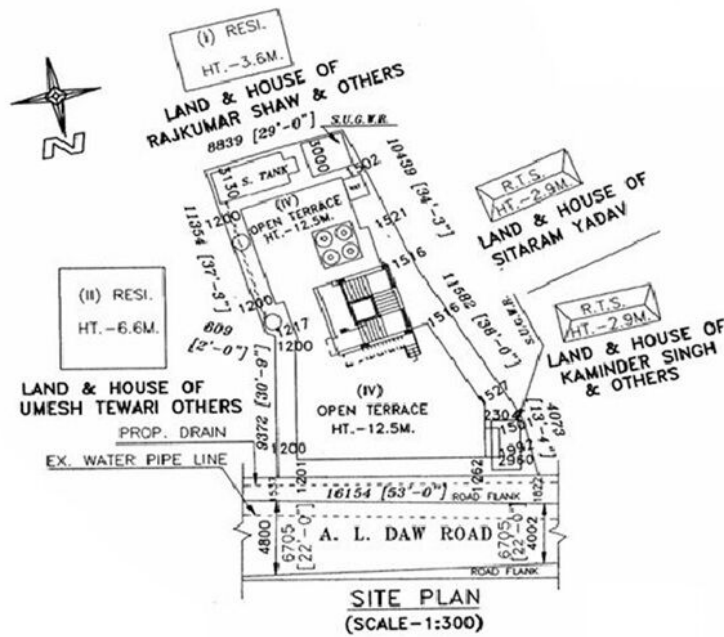

LOCATION PLAN

SCALE :- 1 : 4000

Co - ordinate in WGS 84 and site elevation (AMSL)

Reference points marked in the site plan of the proposal	Co - ordinate in WGS84		Site elevation (AMSL)
	Latitude	Longitude	
A"	22° 29' 58.99" N	88° 18' 16.39" E	4.98 Mts.
	22° 29' 59.64" N	88° 18' 16.54" E	
	22° 29' 58.96" N	88° 18' 16.71" E	
	22° 29' 59.58" N	88° 18' 16.86" E	

Krishnendu Ray

KRISHNENDU RAY
LBS OF K.M.C.
LBS No: 1085, CLASS-I