

PLAN FOR PROPOSED G+III STORIED RESIDENTIAL BUILDING AT PREMISES NO - 314, BRAHMA SAMAJ ROAD, WARD NO. - 130, BOROUGH - XIV, U/ S. 393 (A). OF K.M.C. ACT 1980. ALONG WITH THE K.M.C. BUILDING RULE 2009 AS AMENDED 14.08.2025

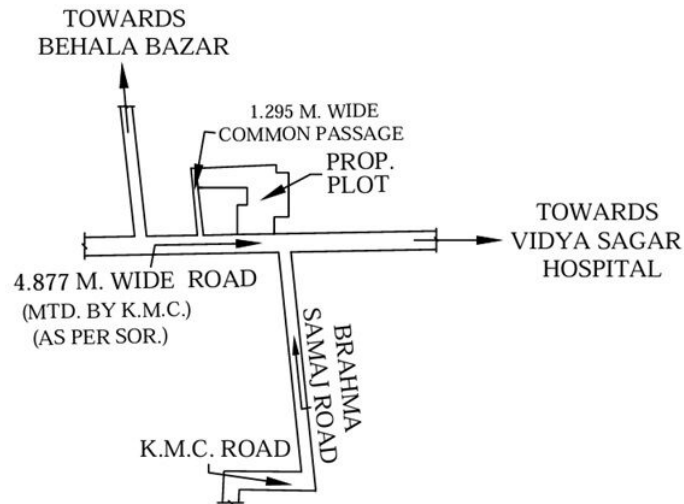

LOCATION PLAN

SCALE :- 1 : 4000

LOCATION PLAN

SCALE :- 1 : 4000

Co - ordinate in WGS 84 and site elevation (AMSL)

Reference points marked in the site plan of the proposal	<u>Co - ordinate in WGS84</u>		<u>Site elevation (AMSL)</u>
	<u>Latitude</u>	<u>Longitude</u>	
A"	22° 29' 58.99" N	88° 18' 16.39" E	4.98 Mts.
	22° 29' 59.64" N	88° 18' 16.54" E	
	22° 29' 58.96" N	88° 18' 16.71" E	
	22° 29' 59.58" N	88° 18' 16.86" E	

Krishnendu Ray

KRISHNENDU RAY
LBS OF K.M.C.
LBS No.: 1085, CLASS-I