

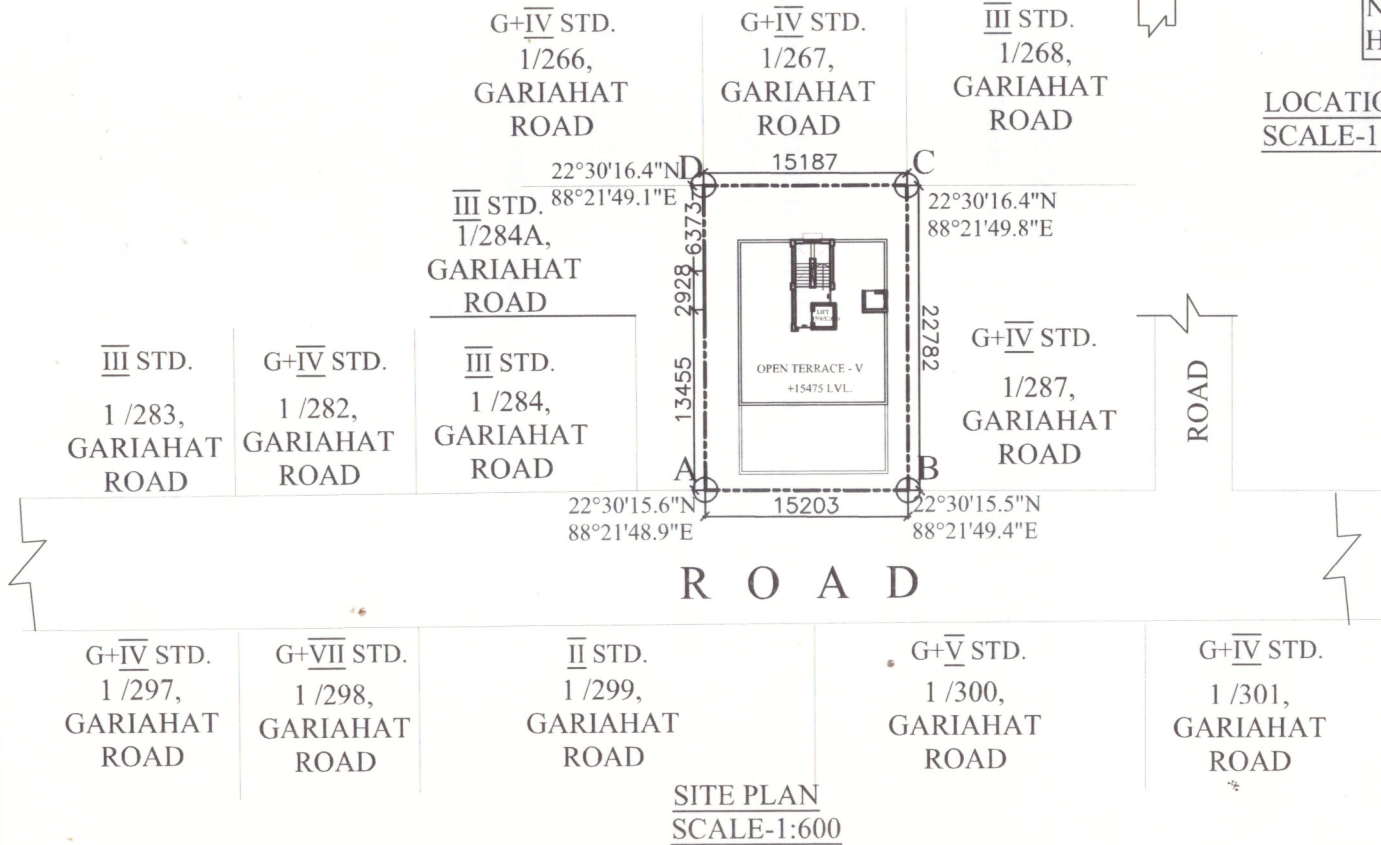

SITE PLAN & LOCATION PLAN OF RESIDENTIAL BUILDING AT- 1/286, GARIAHAT ROAD, (FORMALY KNOWN AS JODHPUR PARK) KOLKATA- 700068, WARD NO.-93, BOROUGH NO.-X, P.S.- LAKE.

TO DHAKURIA BRIDGE

POINT MARK	LATITUDE (N)	LONGITUDE (E)	SITE ELEVATION (AMSL) (MTR)
A	22°30'15.6"N	88°21'48.9"E	6.0
B	22°30'15.5"N	88°21'49.4"E	6.0
C	22°30'16.4"N	88°21'49.8"E	6.0
D	22°30'16.4"N	88°21'49.1"E	6.0

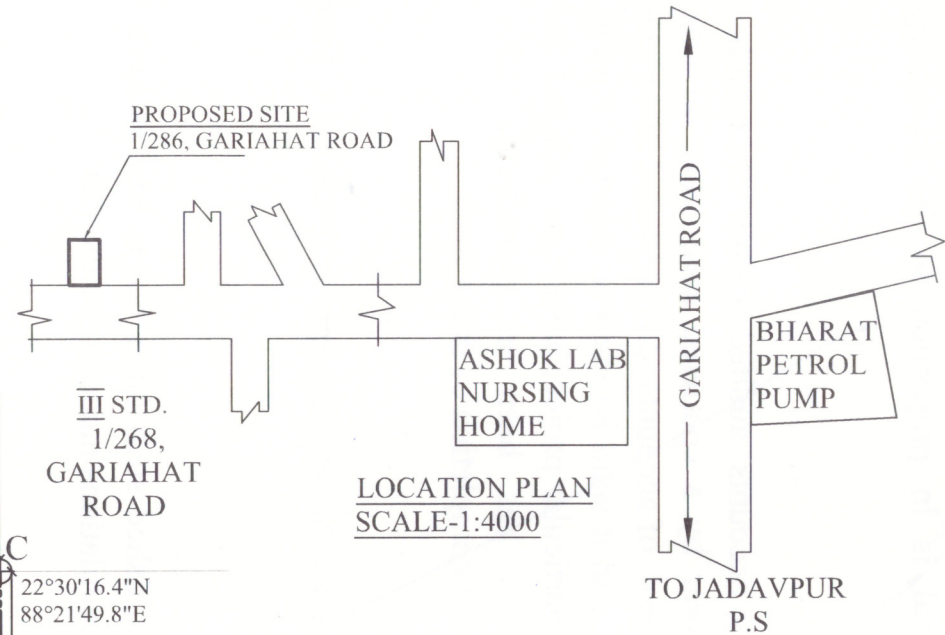



For PRATTAY
Pratay Sarathi Das
 Proprietor



22°30'16.4"N
88°21'49.1"E

22°30'16.4"N
88°21'49.8"E

 Abar Barithak
The coffee shop
আবার কৈঠক দিকফি শপ

 SV Cleaning Service
এসভি ক্লিনিং সার্ভিস

 koyel banquet
কোয়েল ব্যাংকোরেট

 287 Jodhpur Park
Kolkata 700068
287 জোড়পুরপার্ক
কলকাতা 700068
Recently viewed

22°30'15.6"N
88°21'48.9"E

22°30'15.5"N
88°21'49.4"E

Jodhpur Park Rd

Jodhpur Park Rd

 Offbit Marketing Services

 Tepantar
তেপান্তর

Google Maps