

COLUMN LAYOUT
SCALE - 1:100

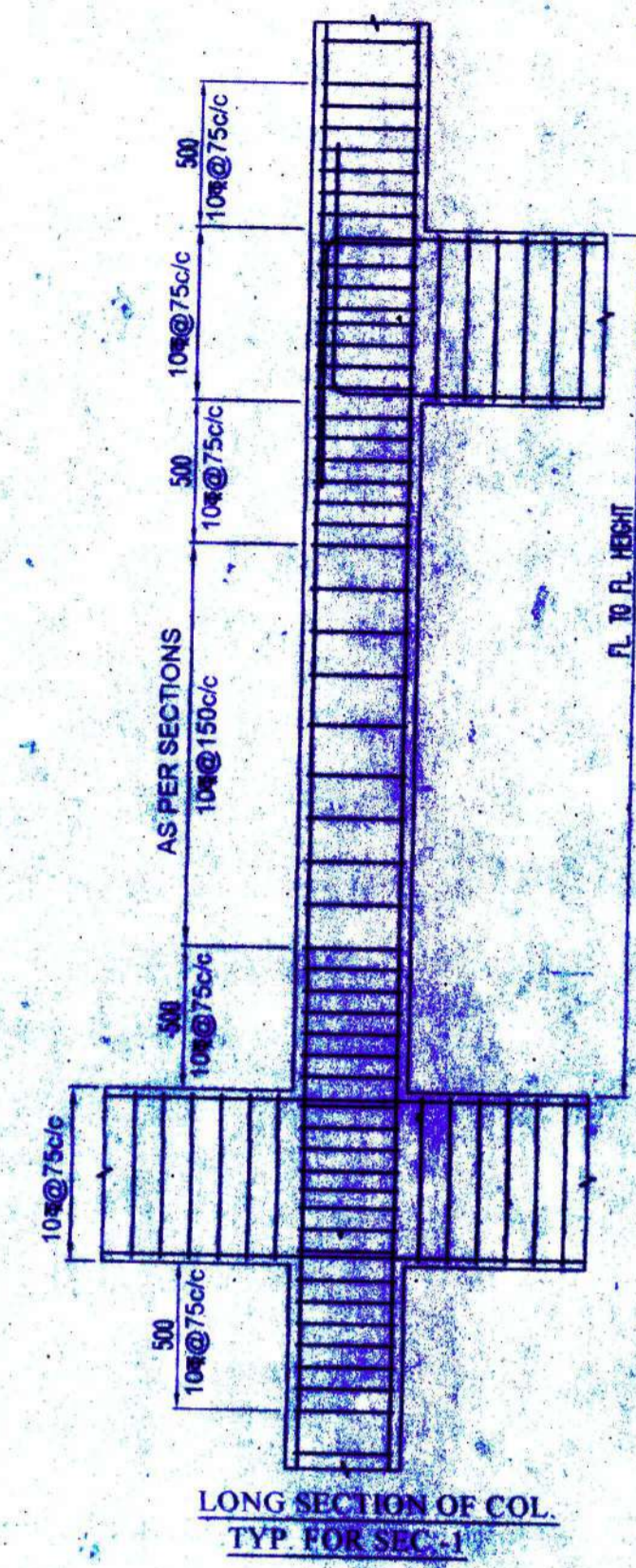

COLUMN SCHEDULE

FLOOR	REINFORCEMENT	SIZE	COLUMN MARKING											LINKS	
			C1, C15, C23	C2, C24, C25	C3, C4, C5, C6, C7	C8	C9, C27	C10	C11, C12, C13, C14, C17, C18, C22	C19	C20	C21	C16, C26		
8TH. FL. TO ROOF	M25: Fe 500	700X300 1000X300	1000X350	1500X300	1635X300 485X300	250X1200	500X500	1000X300	1000X300	1000X300	1200X300	1500X300	400X500	1000X300	AS PER LAYOUT
		STEEL	8-25T+22T	8-25T+14-20T	8-25T+24-20T	8-25T+30-30T	8-25T+14-20T	12-25T+6-20T	12-20T+10-16T	16-25T+26-20T	24-25T+8-20T	12-25T+4-20T	4-25T+18-20T	SEC-1	180-16T
		LINKS	SEC-1	SEC-1	SEC-1	SEC-1	SEC-1	SEC-1	SEC-1	SEC-1	SEC-1	SEC-1	SEC-1	SEC-1	SEC-1
4TH. FL. TO 8TH. FLOOR	M25: Fe 500	700X300 1000X300	1000X350	1500X300	1635X300 485X300	250X1200	500X500	1000X300	1000X300	1000X300	1200X300	1500X300	400X500	1000X300	AS PER LAYOUT
		STEEL	16-25T+14-20T	12-25T+10-20T	16-25T+16-20T	16-25T+22-20T	16-25T+6-20T	12-25T+6-20T	12-20T+10-16T	32-25T+10-20T	24-25T+8-20T	12-25T+4-20T	4-25T+18-20T	SEC-1	180-16T
		LINKS	SEC-1	SEC-1	SEC-1	SEC-1	SEC-1	SEC-1	SEC-1	SEC-1	SEC-1	SEC-1	SEC-1	SEC-1	SEC-1
1ST FL. TO 4TH. FL.	M30: Fe 500	700X300 1000X300	1000X350	1500X300	1635X300 485X300	250X1200	500X500	1000X300	1000X300	1000X300	1200X300	1500X300	400X500	1000X300	AS PER LAYOUT
		STEEL	24-25T+6-20T	16-25T+6-20T	20-25T+12-20T	24-25T+14-20T	22-25T	18-25T	22-20T	42-25T	32-25T	16-25T	12-25T+10-20T	40-20T+140-16T	SEC-1
		LINKS	SEC-1	SEC-1	SEC-1	SEC-1	SEC-1	SEC-1	SEC-1	SEC-1	SEC-1	SEC-1	SEC-1	SEC-1	SEC-1
FOUNDATION TO 1ST. FLOOR	M30: Fe 500	700X300 1000X300	1000X350	1500X300	1635X300 485X300	250X1200	500X500	1000X300	1000X300	1000X300	1200X300	1500X300	400X500	1000X300	AS PER LAYOUT
		STEEL	30-25T	22-25T	24-25T+8-20T	38-25T	22-25T	18-25T	4-25T+18-20T	42-25T	32-25T	16-25T	16-25T+6-20T	60-20T+120-16T	SEC-1
		LINKS	SEC-1	SEC-1	SEC-1	SEC-1	SEC-1	SEC-1	SEC-1	SEC-1	SEC-1	SEC-1	SEC-1	SEC-1	SEC-1
COLUMN MARKING															LIFT-1

May be Approved
Sub Assst Engineer
Midnapore Municipality
RECOMMENDED

Member
Chairman - In - Council
Midnapore Municipality

SIGNATURE OF OWNER: **GRAND SPACE INFRA** K.B. ENTERPRISE
Srinivasa Samra, Sridhan Kumar Das, Sudipta Bose, Bijoykandan, Anandheela Sankar
Partner PARTNER

SIGNATURE OF ARCHITECT: **SHILPI GHATAK** ARCHITECT
Reg. No.: CA/2014/65632
SIGNATURE OF ARCHITECT

SIGNATURE OF STRUCTURAL ENGINEER: **Mainak Majumdar**
B.C.E., M.C.E. (Struct)
ESE-152/1 of KMC
ESR-(I), 152/4
STRUC.Rev.-SMC/1
SIGNATURE OF STRUCTURAL ENGINEER

SIGNATURE OF GEO-TECHNICAL ENGINEER: **JAYANTA MAJUMDAR**
B.E., M.E., M.I.G.S.
Geotechnical Engineer
Chief of Urban Development & Municipal Affairs, Govt. of West Bengal
Rajpur-Suburban Municipality
Class-1, LIC. No. - 006, G.T. ENG.
Kolkata Municipal Corporation
Class-1, LIC. No. - 13, G.T.E.
New Town Kolkata Development Authority
Class 1, LIC. No. H1DCR/100007
SIGNATURE OF GEO-TECH ENGINEER

SIGNATURE OF STRUCTURAL REVIEWER: **MANOJ KANTI MAJUMDAR**
B.Sc. (Hons), B.C.E., F.I.E.C. (USA)
ESE-18 of
The Calcutta Municipal Corporation
SIGNATURE OF STRUCTURAL REVIEWER

TYPE OF DRAWING - **SANCTION DRAWING**

TITLE - **COLUMN LAYOUT & DETAIL**

PROJECT
PROPOSED EIGHTH TO ELEVENTH FLOOR OVER ALREADY SANCTIONED B+C+7 STORED RESIDENTIAL CUM COMMERCIAL APARTMENT OF LAND OWNER K.B. ENTERPRISE AND DEVELOPER GRAND SPACE INFRA, AT MOUZA - CANTONMENT BARPATHAR, J.L. NO. - 168, L.R. PLOT NO. - 544/867, 544/869, HOLDING NO. - 950, P.W.D. ROAD, L.R. KHATIAN - 2483, P.O. - MIDNAPORE, P.S. - MIDNAPORE, DIST. - PASCHIM MEDINIPUR, PIN - 721101

STRUCTURAL CONSULTANT: **ADROIT CONSULTANT**
102, PANCHANANTALA ROAD
KOLKATA 700029

APPROVED BY: MM DRG. NO. - MIDNAPORE MUD/MS/ST-03
DRAWN BY: SD SCALE - 1:100, 50, 25 DATE - 26.12.24
APPROVAL FROM STATUTORY AUTHORITY