



SITE PLAN SHOWING THE AREA OF PROPOSED RESIDENTIAL APARTMENT BUILDING OF " **K.B. ENTERPRISE**" PARTNERS- **1. KALYAN KUMAR DHARA**, S/O- LT. SHYAMCHARAN DHARA AT HANSPUKUR, P.O. + P.S.- MIDNAPORE, DIST- PASCHIM MEDINIPUR, **2. BIJOY KUMAR DAS**, S/O- LT. PURNA CHANDRA DAS AT CHIRIMARSAI, P.O. + P.S.- MIDNAPORE, DIST- PASCHIM MEDINIPUR ON MOUZA- **CANTONMENT BARPATHAR**, J.L. NO. - **168**, R.S. & L.R. PLOT NO- **544/867(P), 544/869(P)**; P.S.- MIDNAPORE, DIST-PASCHIM MEDINIPUR, UNDER MIDNAPORE MUNICIPALITY AREA.

DEVELOPER'S- "GRAND SPACE INFRA" REPRESENTED BY-
1. SRI ARDHENDU SARKAR, S/O- SRI AMALENDU SARKAR,
2. SRI SWAPAN KUMAR JANA, S/O- LT. TARAK BRAHMA JANA,
3. SRI SUDIPTA BOSE, S/O- TULSI CHARAN BOSE,
4. SRI SUBRATA SARKAR, S/O- BHUJANGA BHUSAN SARKAR,
5. SRI BIJOY KUMAR DAS, S/O- LT. PURNA CHANDRA DAS
 AT ALIGUNJ, LIBRARY ROAD, P.O.- MIDNAPORE, P.S.- KOTWALI,
 DIST- PASCHIM MEDINIPUR.

[ALL DIMENSIONS ARE IN MTR. & SCALE-1:450]

AREA OF TOTAL LAND = 930.77 SQ. M. - 
 PRO. AREA OF CONSTRUCTION MARKED AS- 
 MAX. PERMISSIBLE CONSTR. AREA= 465.39 SQ. M= 50.00 % OF TOTAL PLOT AREA
 PRO. HEIGHT OF CONSTRUCTION - 20.0 MTR.



Latitude-22.4283060
 Longitude-87.3217870

DRAWN BY-

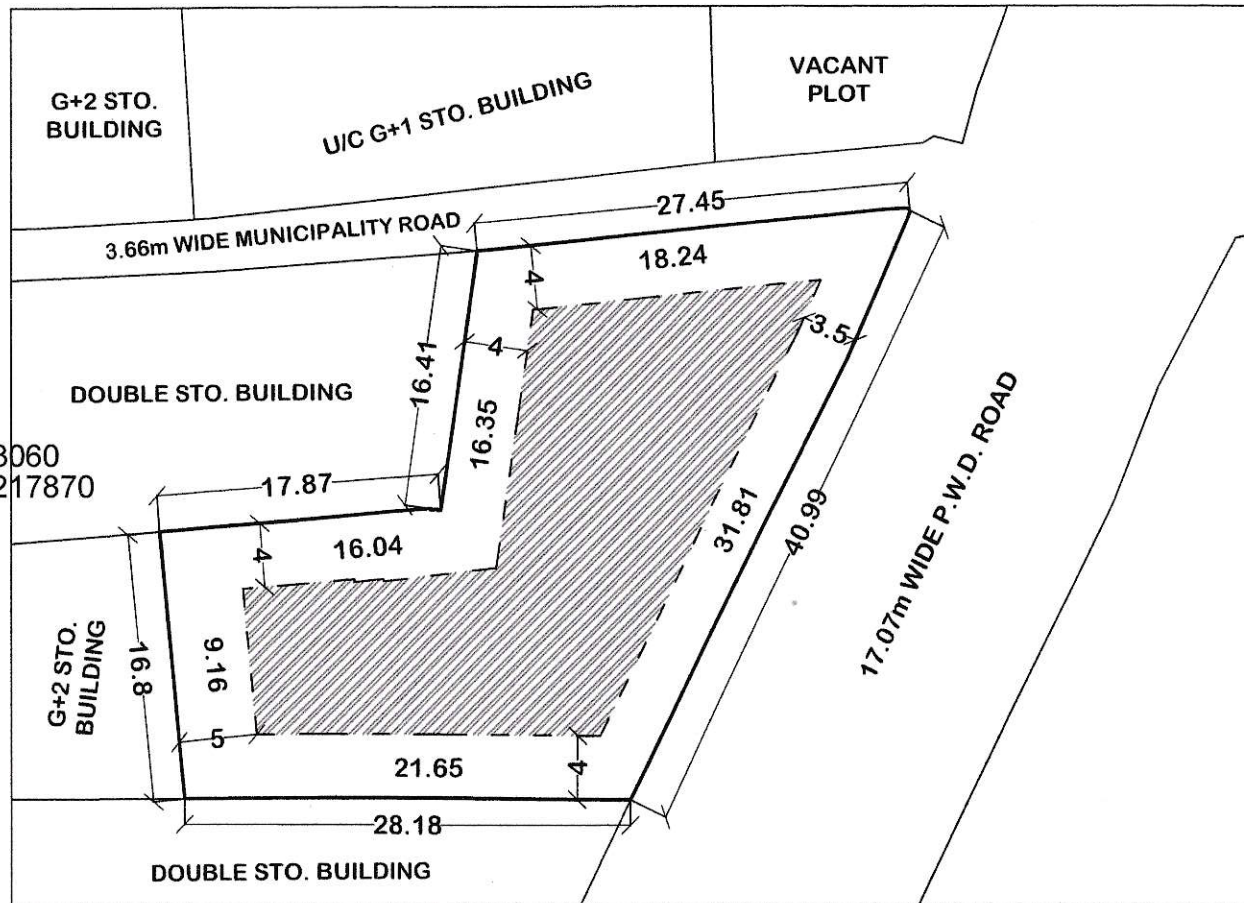

①

②

SIGNATURE OF THE
 LAND OWNER'S

GRAND SPACE INFRA
 Partner

SIGNATURE OF THE
 DEVELOPER'S