

PLAN OF ELECTRICAL SUBSTATION

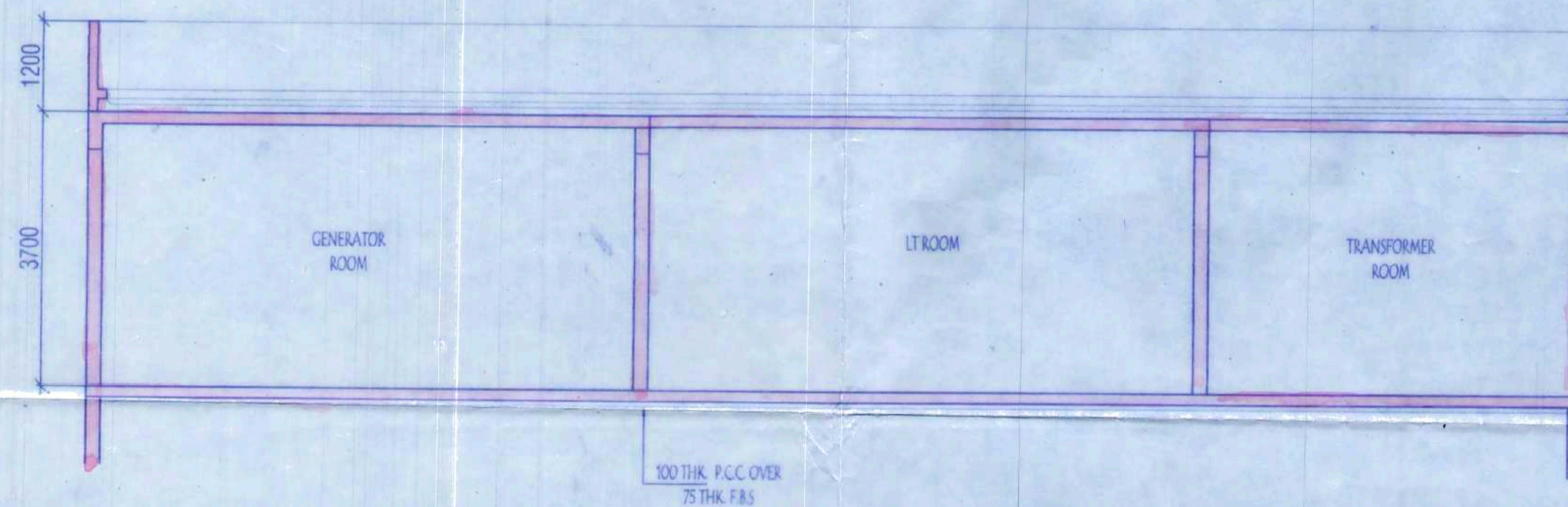

SECTION AT C-C

PROJECT

PROPOSED AFFORDABLE HOUSING UNDER PRADHAN MANTRI AWAS YOJANA AT PRE. NO.39/1 SHALIMAR ROAD, MOUZA SHIBPUR SHEET NO.169,170,179,180, J.I. NO. 1, L.R. KHATIAN NO. 170,9,15,17, L.R. DAG NO. 12,13,39,40,41,42,44,45,60,61,62,63,6,7,8,9,10,11,12,13, 14,15,16,17,21,22,24,1,2,11 P.S-SHIBPUR, WARD NO-39, BOROUGH -V, DIST HOWRAH-711103, UNDER HOWRAH MUNICIPAL CORPORATION. WEST BENGAL.

TITLE :

ELECTRICAL SUBSTATION AND SECTION AT C-C

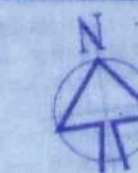

SPECIFICATION

1. ALL DIMENSIONS ARE IN MM UNLESS IT IS MENTIONED.
2. ALL EXTERNAL BRICK WALLS ARE 200 MM THICK AND INTERNAL 100 MM THICK.
3. ALL BRICKWORK PLASTERING INSIDE OR OUTSIDE ARE IN THE RATIO OF 1:3:5 AND OUTSIDE PLASTERING CONTAINS WATER PROOFING.
4. ALL CIVIL WORKS ARE AS PER IS 456 AND ALL REINFORCEMENT AS PER IS 1176.
5. ALL R.C.C. WORKS ARE IN THE RATIO M-25.
6. ALL PRECAUTIONARY MEASURES SHALL BE TAKEN AT THE TIME OF CONSTRUCTION.
7. DEPTH OF WATER RESERVOIR SHALL NOT BE MORE THAN THE DEPTH OF MAIN COLUMN FOUNDATION.

For IDEAL RIVERVIEW PROJECTS PRIVATE LIMITED

S.K. [Signature]  
Director

SIGNATURE OF OWNER

WE DO HEREBY CERTIFY THAT THE FOUNDATION AND SUPERSTRUCTURE OF THE BUILDING PROPOSED FOR CONSTRUCTION AT PRE. NO.39/1 SHALIMAR ROAD, WARD NO-39, BOROUGH -V, HOWRAH-711103, DISTRICT HOOGHLY, WEST BENGAL HAVE BEEN SO DESIGNED BY ME / US WILL MAKE SUCH FOUNDATION AND SUPERSTRUCTURE SAFE IN ALL RESPECT INCLUDING THE CONSIDERATION OF BEARING CAPACITY AND SETTLEMENT OF SOIL ETC.

SIGNATURE OF GEOTECHNICAL ENGINEER

C. E. TESTING COMPANY PVT. LIMITED  
DR. M. NAYAK  
124A, N.S.C. BOSE ROAD, KOLKATA - 700 092

BIBEK BHASH MULLICK  
E.S.E. - I/75  
KOLKATA MUNICIPAL CORPORATION

A. D. CHATTERJEE  
B.C.E. (Jadavpur), D.C.T. (Battersee, U.K.)  
M.Sc. Struct. Eng. (Surrey, U.K.)  
C.Eng., M.I.C.E. (U.K.), MASCE (L.S.)  
F.I.E. Reg. No. 011134/8  
KMC Empanelled Structural Engineer, Class-1, E.S.E. I/7

SIGNATURE OF STRUCTURAL ENGINEERS

BIBEK BHASH MULLICK

SIGNATURE OF STRUCTURAL REVIEWER  
ARUN BHASH CHOUHURY  
H.M.C./ST.BHGG./CLASS-1/LIC NO. 38

MALAY KUMAR GHOSH  
Regn. No. CA/92/14854  
35A, Dr. Sarat Banerjee Road  
Kolkata - 700 029

SIGNATURE OF ARCHITECT / I.C.A. / LIC NO. 87  
MALAY KUMAR GHOSH  
REGN. NO. CA/92/14854  
35A, DR. SARAT BANERJEE ROAD,  
KOLKATA-700 029

SCALE	1:75	REF. NO.	
DATE	27.11.19	DRG. NO.	ESP/2019/SHALIMAR/SANC/ARCH-14-02
DEALT	P.D	DESIGNED	M.G

ARCHITECTS

ESPACE  
35A, DR. SARAT BANERJEE ROAD, KOLKATA 700-029  
PH.NO- 2465-4130,4159

ALOK ROY  
Empanelled Geotechnical Engineer  
Kolkata Municipal Corporation  
Class-1, No-9, T/11  
8A, Milan Park  
Kolkata-700 084

THIS DRAWING IS A PROPERTY OF ESPACE, 35 A, SARAT BANERJEE ROAD, KOLKATA-700 029. ANY MODIFICATION CHANGES DEVIATIONS IS NOT PERMISSIBLE WITHOUT PRIOR INTIMATION TO ESPACE IN THE CONTRARY. THE H.M.C./G.T.E./LIC NO. 3





APPLICANT HAS TO EXHIBIT AT A CONSPICUOUS PLACE:

PREMISES NO :-  
NAME OF THE LBA, LBS :-  
NAME OF THE STRUCTURAL ENGG. :-  
NAME OF THE GEO-TECHNICAL ENGINEER :-  
NAME OF OWNER :-  
NAME OF THE APPLICANT :-  
BUILDING PERMIT :-

THE SANCTION IS VALID

UP TO... 22/11/2024

APPROVED AS PER ORDER OF

COMMISSIONER Dt. 20/3/21

The applicant shall keep at the site one set of plans and Specifications and shall also exhibit at a conspicuous place the number of the Premises. The Name of the Architect or Licensed Building Surveyor, Structural Engineer and Geo Technical Engineer Name of Owner and number and date of the Building Permit.

CONSTRUCTION SITE SHALL BE MAINTAINED TO PREVENT MOSQUITO BREEDING IN SUCH MANNER SO THAT ALL WATER COLLECTION & PARTICULARLY LIFT WELLS, VATS, BASEMENT CURING SITES, OPEN RECEPTACLES ETC. MUST BE EMPTIED COMPLETELY TWICE A WEEK.

Sanctioned Conditionally on undertaking from the owner that if any part of the building to be constructed falls within the alignment of HMC, the same will be demolished by the owner at his/her risk and for this the owner will not claim any compensation from HMC

Plan for water connection arrangement SEMI U. G. should be submitted at the Office of the Assistant Engineer of Borough and sanction to be obtained before proceeding with the work of Water Supply. Any deviation may lead to disconnection / demolition.

No rain water pipe should be fixed or discharged on Road or Footpath. Drainage plan should be submitted at the Borough Assistant Engineer's Office and the sanction obtained before proceeding with the drainage work.

**PARTY'S COPY**



Structural plan and design calculation as submitted by the structural engineer have been kept with B.P. No. 256/19-20 Date: 12/12/20 for record of the Howrah Municipal Corporation without verification No deviation from the submitted structural plan should be made at the time of erection without submitting fresh structural plan along with design calculation and stability certificate in the prescribed form, necessary steps should be taken for the safety of the adjoining premises public and private properties and safety of Human Life during construction.

Executive Engineer  
Building Department  
Howrah Municipal Corporation

PLACED IN MUNICIPAL

BUILDING COMMITTEE

DATED... 06/02/20

Sanctioned subject to demolition of existing structure to provide open space as per plan before construction is started.

Before starting any Construction the site must conform with the plans sanctioned and all the conditions as proposed in the plan should be fulfilled.

The validity of the written permission to execute the work is subject to the above conditions.

The Building Materials necessary for construction should conform to standard specified in the National Building Code of India.

Design of all structural Members including that of the foundation should conform to Standards specified in the National Building Code of India.

Non Commencement of Erection / Re-Erection within Two Year will Require Fresh Application for Sanction.

**RESIDENTIAL BUILDING**

**DEVIATION WOULD MEAN DEMOLITION**

Necessary steps should be taken for the safety of the lives of the adjoining public and private properties during construction. Also to avoid pollution as per WB/CB Guidelines in VAGUE.

CORRECTION PLAN  
BRC No. 256/19-20 Ward No. 21

Substation  
20/11/21  
Asst. Engineer  
Bldg. Department  
Howrah Municipal Corporation