



# CHATTERJEE Construction

Natunpally, Sonarpur, Kolkata-700150

LOCATION PLAN SHOWING THE SITE OF PROJECT- "SERENE TEMPLE CITY PHASE-V" AT MOUZA - SONARPUR, J.L. NO.- 39, R.S. & L.R. DAG NO.- 1772, R.S KHATIAN NO.- 501, L.R KHATIAN NO.- 7276, HOLDING NO.- 158 NATUNPALLI (PASCHIM), WARD NO.- 12 UNDER RAJPUR - SONARPUR MUNICIPALITY, P.S - SONARPUR, DIST.- SOUTH 24 PARGANAS, KOL.-700150. SCALE - N.T.S



**CHATTERJEE CONSTRUCTION**

*Anup Chatterjee*  
Proprietor

PROJECT SITE OF "SERENE TEMPLE CITY PHASE-V"  
(Latitude: 22.4524225 , Longitude: 88.3892927)

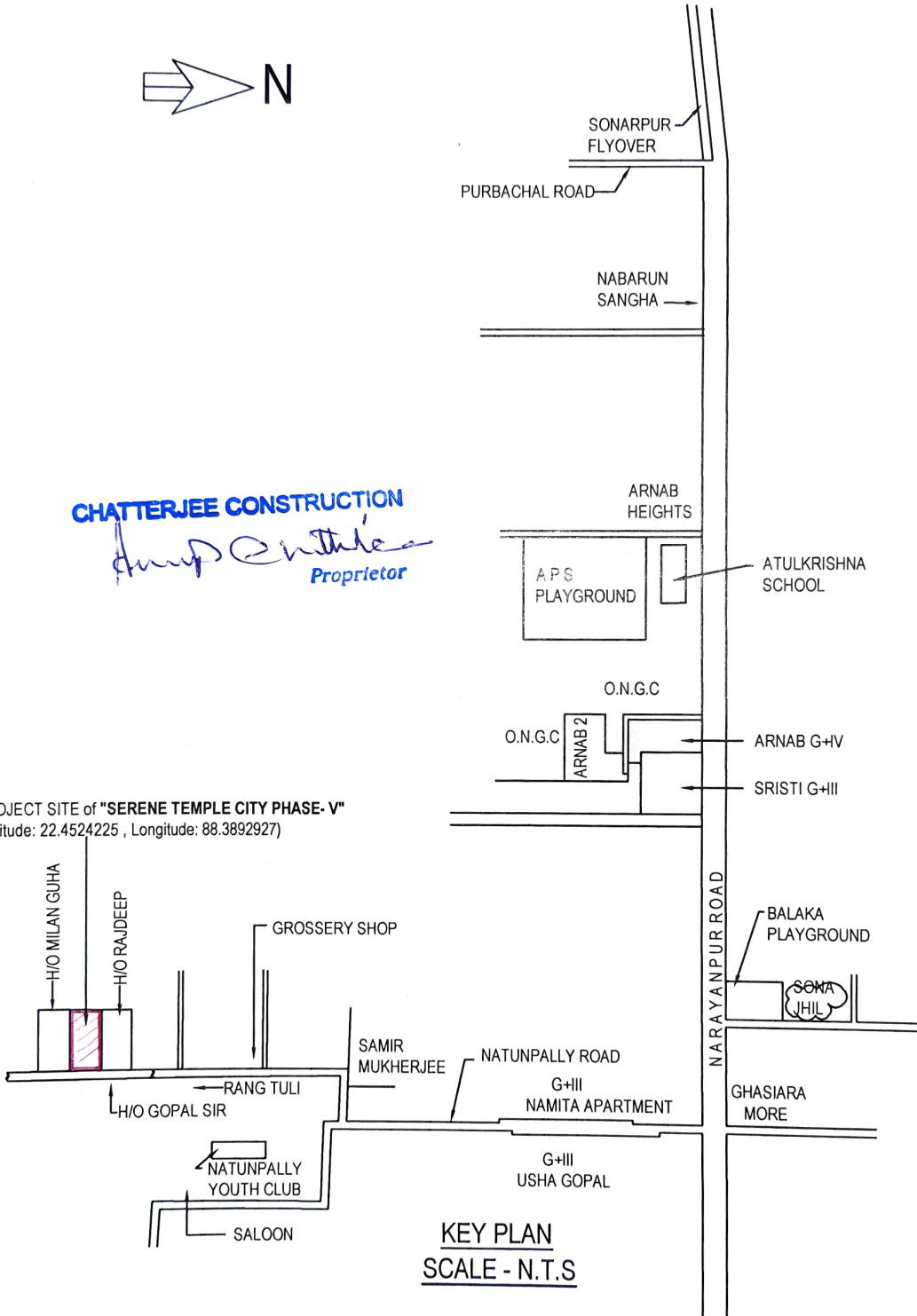

**KEY PLAN**  
**SCALE - N.T.S**