

PLAN FOR PROPOSED G+III RESIDENTIAL FLAT BUILDING OF SMT. LILA RANI GHOSH W/O LATE NONI GOPAL GHOSH MOUZA - ICHLABAD, J.L. NO.- 75, R.S. PLOT NO.- 870, R.S. KH. NO.- 474, L.R. PLOT NO.-2459, L.R. KH. NO.- 1335, AT MAHALLA - G. T. ROAD EAST END, WARD NO.- 11, HOLDING NO.- 04, MOUZA - ICHLABAD, UNDER BURDWAN MUNICIPALITY, P.S. - BARDHAMAN SADAR, DIST - PURBA BURDWAN. AREA OF LAND (AS PER SITE) = 4702 Sq. ft. 436.83 Sq.M.

COVERED AREA = 299.86 SQ.M.
 MAX. RAINFALL IN 15 MINUTES FOR LAST 20 YEARS = 80.00
 COEFFICIENT OF RAINFALL = 0.85
 SO RAINFALL VOLUME = AS RAC = 249.89 CU.M.
 = 3.71 CU.M.
 = 6.71 LTR.

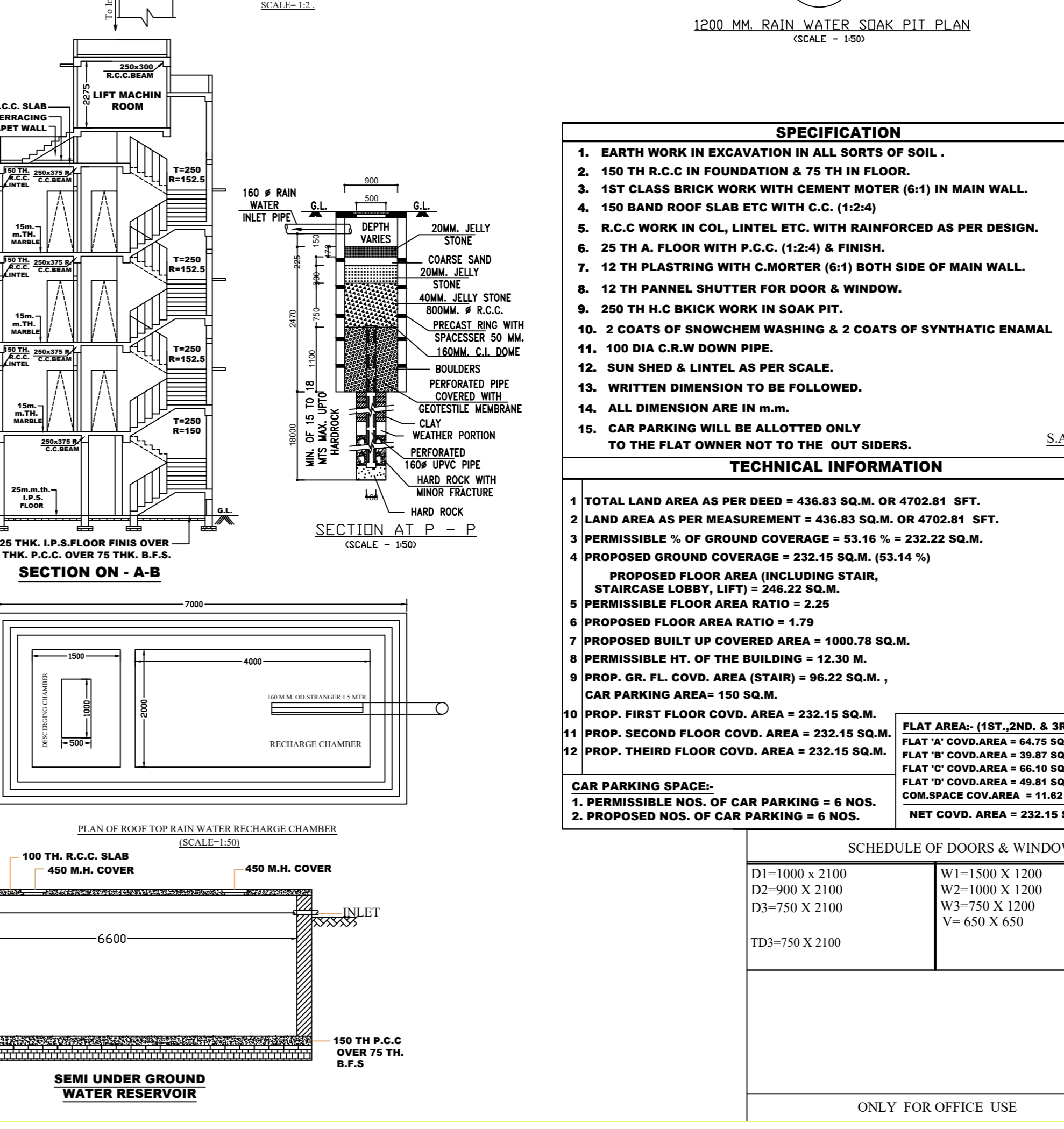
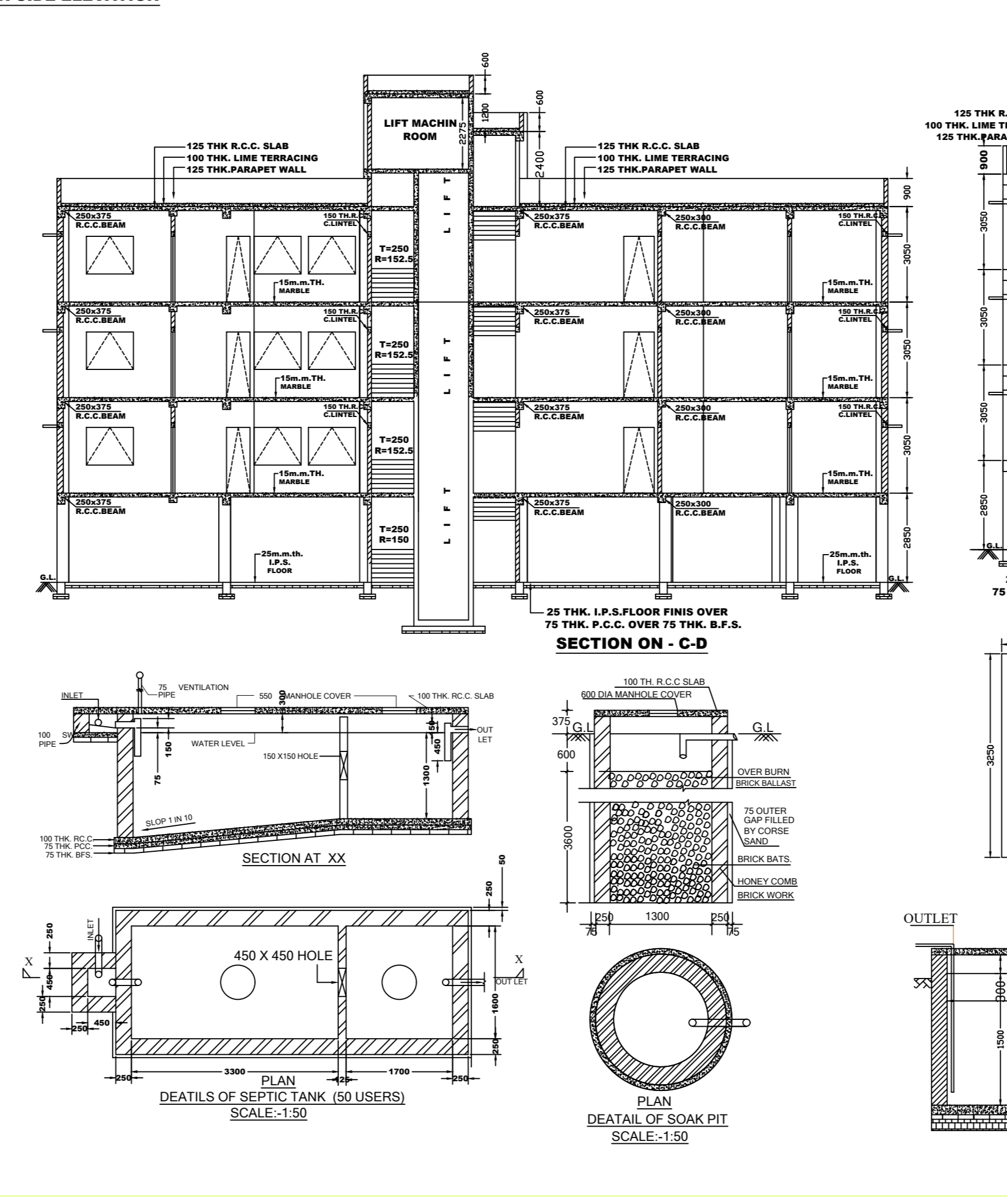
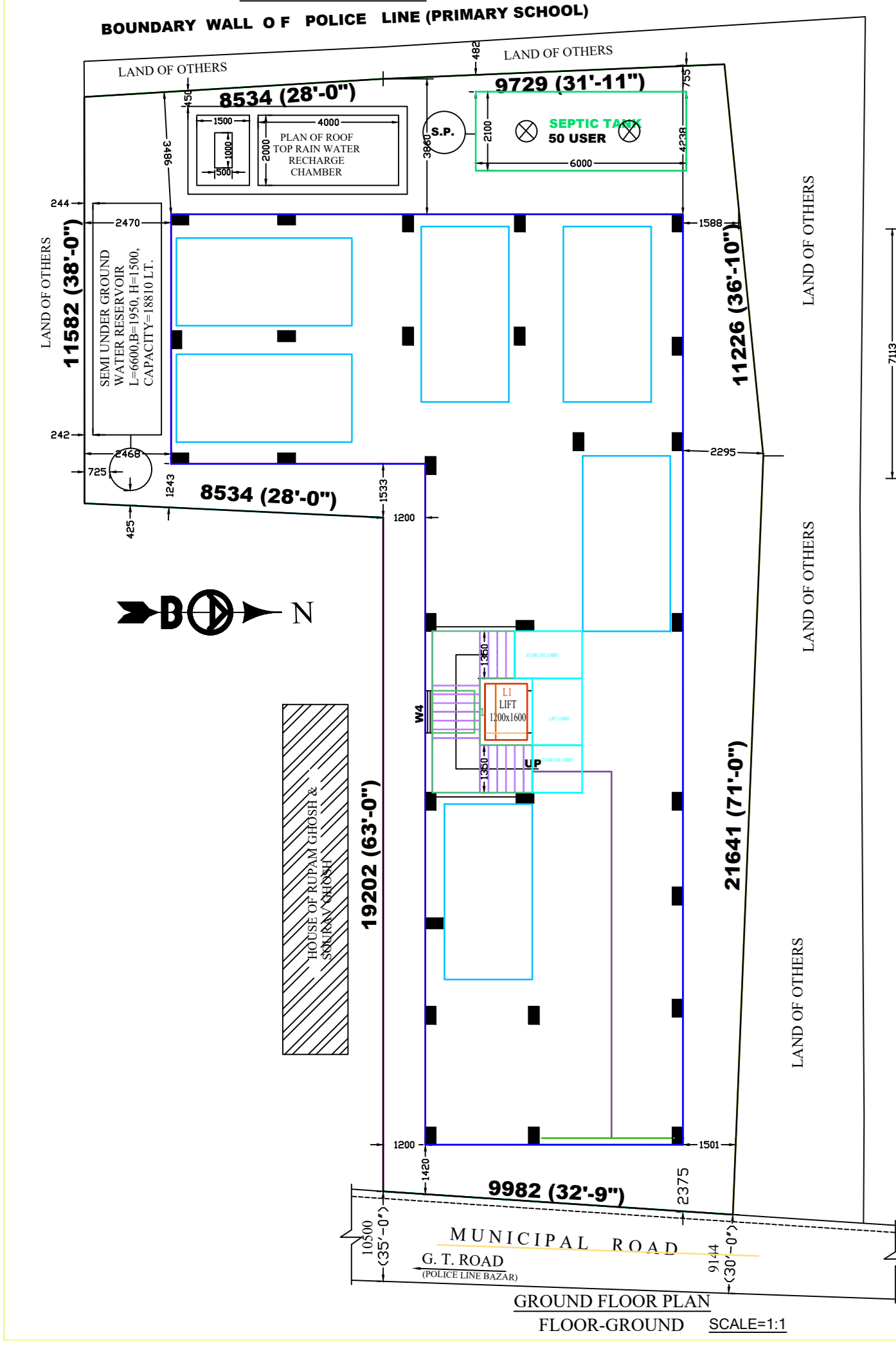
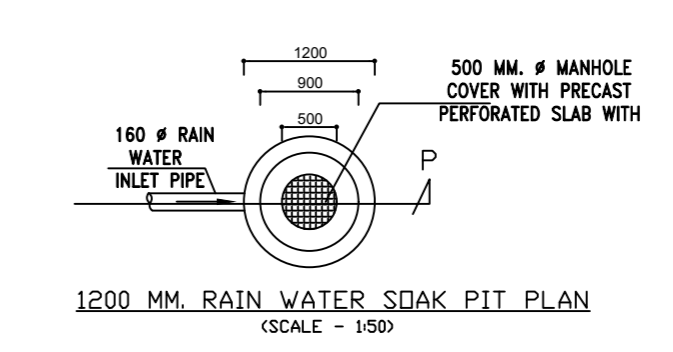

SITE PLAN FOR PROPOSED G+III RESIDENTIAL FLAT BUILDING OF SMT. LILA RANI GHOSH W/O LATE NONI GOPAL GHOSH MOUZA - ICHLABAD, J.L. NO.- 75, R.S. PLOT NO.- 870, R.S. KH. NO.- 474, L.R. PLOT NO.- 2459, L.R. KH. NO.- 1335, AT MAHALLA - G. T. ROAD EAST END, WARD NO.- 11, HOLDING NO.- 04, MOUZA - ICHLABAD, UNDER BURDWAN MUNICIPALITY, P.S. - BARDHAMAN SADAR, DIST - PURBA BURDWAN. AREA OF LAND (AS PER SITE) = 4702 Sq. ft. 436.83 Sq.M.

LAND AREA = 4702.81 SFT. OR 436.83 SQ.M.
 NATURE OF LAND :- " BASTU "

