

PROJECT.

PREMISES NO. 1177, MAHATMA GANDHI ROAD,
WARD NO:-124, BOROUGH NO:-XVI,
UNDER THE KOLKATA MUNICIPAL CORPORATION.

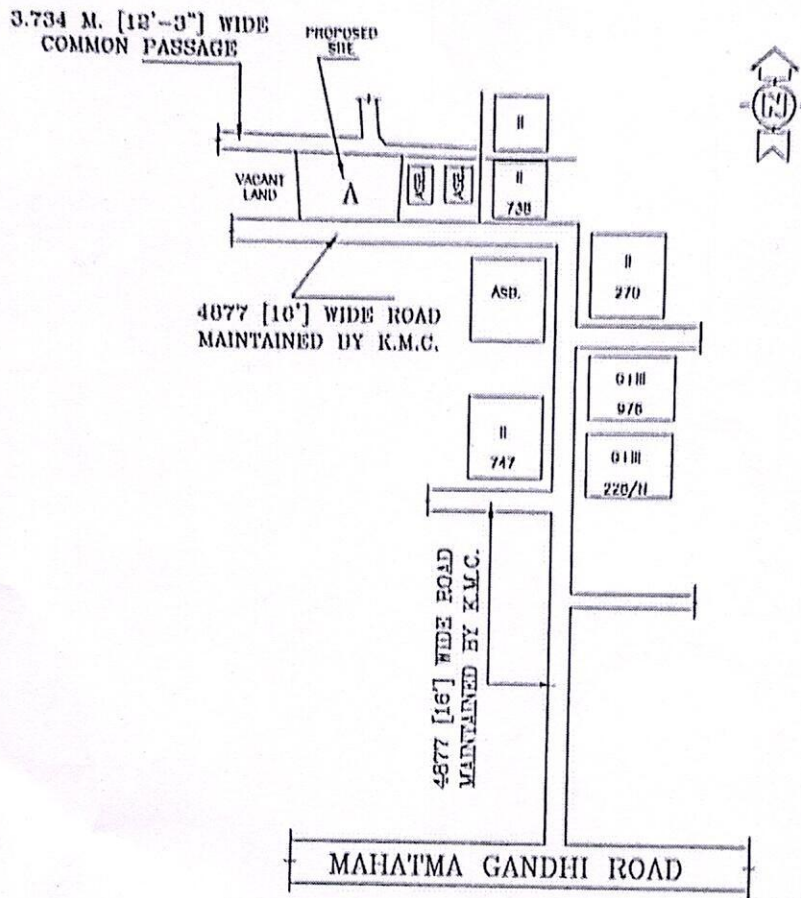

LOCATION PLAN
SCALE=1:4000

CO-ORDINATE IN WGS 84 AND SITE ELEVATION (AMSL)

REFERENCE POINTS MARKED IN THE SITE PLAN OF THE PROPOSAL	CO-ORDINATE IN WGS 84		SITE ELEVATION (AMSL)
	LATITUDE	LONGITUDE	
"A"	22°27'35.81"N	88°19'22.04"E	4.0 M.

Smritish Mondal

SMRITISH MONDAL
L.B.S. No. 1188, Class- I
The Kolkata Municipal Corporation
821, D. H. Road, Kolkata-700 008
SMRITISH MONDAL
L.B.S.-1188(I)
SIGN. OF L.B.S.