

PLAN FOR REGULARISATION U/R-26 (2a) OF A
 G+FOUR STORIED RESIDENTIAL BUILDING PLAN
 U/S 393A OF K.M.C. ACT. 1980 AT &
 K.M.C.B/R-2009 PREMISES NO. 975, MADURDAH
 ,WARD 108, BOROUGH-XII, OF MOUZA -
 MADURDAH, OF R.S. DAG NO.455, R.S. KHATIAN
 NO. 190 , J.L. NO. -12 , P.S. - ANANDAPUR
 VIDE B.P. NO. 2021120054, DT. 17.04.2021

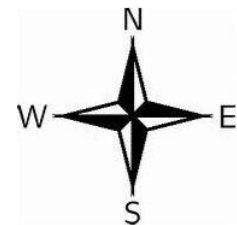
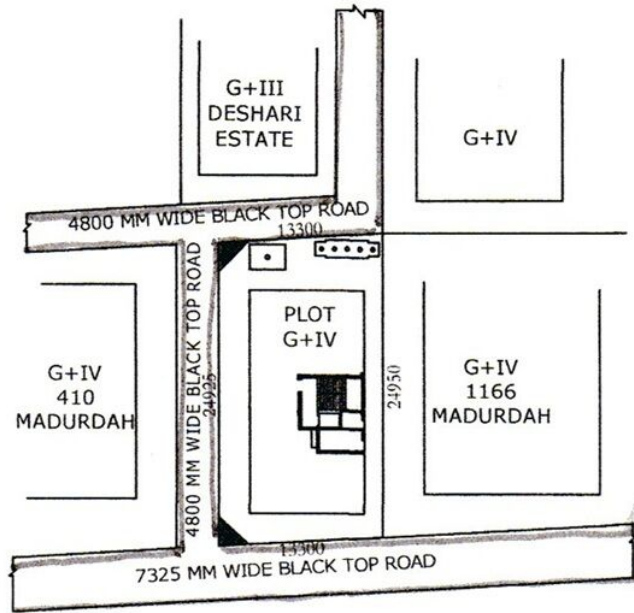

SITE PLAN

SCALE - 1:600

LOCATION PLAN

SCALE :- 1 : 4000

Co - ordinate in WGS 84 and site elevation (AMSL)

Reference points marked in the site plan of the proposal	Co - ordinate in WGS84		Site elevation (AMSL)
	Latitude	Longitude	
A"	22° 29' 58.99" N	88° 18' 16.39" E	4.98 Mts.
	22° 29' 59.64" N	88° 18' 16.54" E	
	22° 29' 58.96" N	88° 18' 16.71" E	
	22° 29' 59.58" N	88° 18' 16.86" E	

Krishnendu Ray

KRISHNENDU RAY
 LBS OF K.M.C.
 LBS No.: 1085, CLASS-I