

LOCATION PLAN AT PREMISES NO. - 48, ATABAGAN IN WARD NO. - 111  
OF BOROUGH NO. XI, P.S.- BANSDRONI, KOLKATA :- 700084 UNDER THE  
KOLKATA MUNICIPAL CORPORATION,

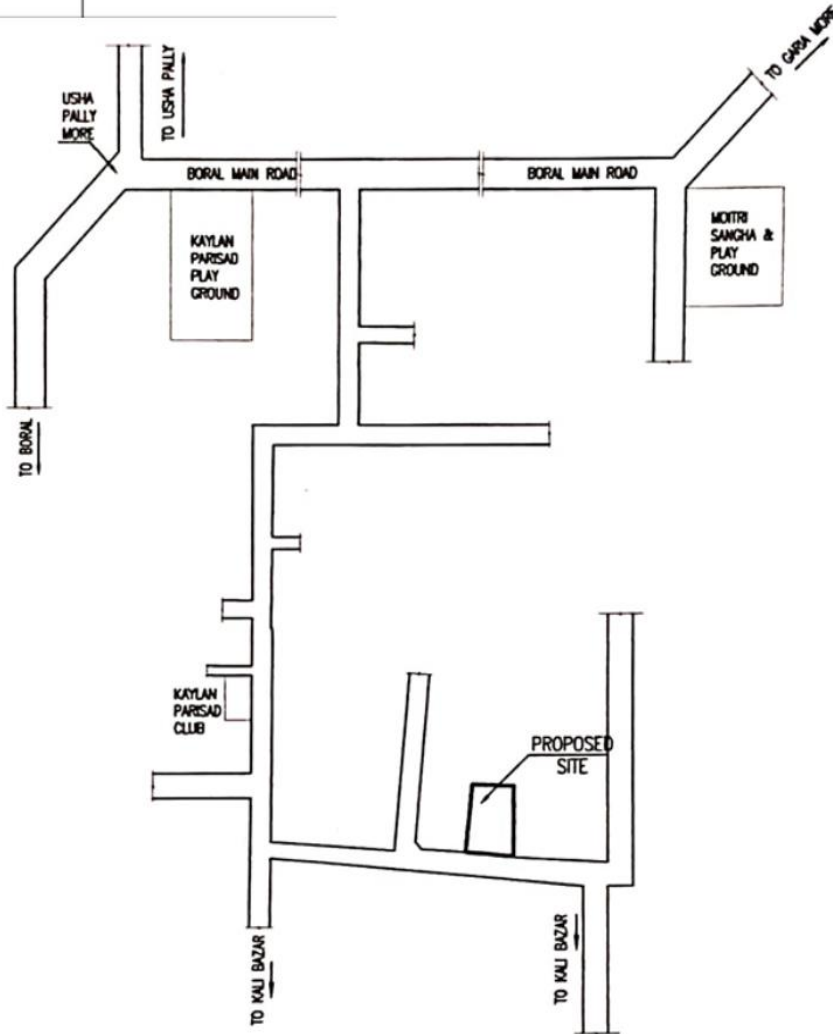

Latitude	Longitude
22°27'19"N	88.22'48"E



LOCATION PLAN

*Sudhangshu Lahiri*  
**SUDHANGSHU LAHIRI**  
 L.B.S NO.: 329 CLASS- I  
 Mob. No.: 9339799711

SUDHANGSHU LAHIRI  
 L.B.S. NO. 329(I)  
SIG. OF L.B.S.

SOUMYA CONSTRUCTION  
*Soumyajit Hait*

Proprietor

.....  
 Signature of Applicant