

NOTES:

1. ALL DIMENSIONS ARE IN METERS UNLESS OTHERWISE SPECIFIED.
2. ALL WALLS ARE 230MM THICK UNLESS OTHERWISE SPECIFIED.
3. ALL DOORS ARE 900MM WIDE UNLESS OTHERWISE SPECIFIED.
4. ALL WINDOWS ARE 1200MM WIDE UNLESS OTHERWISE SPECIFIED.
5. ALL ROOFS ARE 10% PITCH UNLESS OTHERWISE SPECIFIED.
6. ALL ROOFING IS TO BE AS PER LOCAL CODES.
7. ALL ROOFING IS TO BE AS PER LOCAL CODES.
8. ALL ROOFING IS TO BE AS PER LOCAL CODES.
9. ALL ROOFING IS TO BE AS PER LOCAL CODES.
10. ALL ROOFING IS TO BE AS PER LOCAL CODES.

GENERAL NOTES:

1. ALL DIMENSIONS ARE IN METERS UNLESS OTHERWISE SPECIFIED.
2. ALL WALLS ARE 230MM THICK UNLESS OTHERWISE SPECIFIED.
3. ALL DOORS ARE 900MM WIDE UNLESS OTHERWISE SPECIFIED.
4. ALL WINDOWS ARE 1200MM WIDE UNLESS OTHERWISE SPECIFIED.
5. ALL ROOFS ARE 10% PITCH UNLESS OTHERWISE SPECIFIED.
6. ALL ROOFING IS TO BE AS PER LOCAL CODES.
7. ALL ROOFING IS TO BE AS PER LOCAL CODES.
8. ALL ROOFING IS TO BE AS PER LOCAL CODES.
9. ALL ROOFING IS TO BE AS PER LOCAL CODES.
10. ALL ROOFING IS TO BE AS PER LOCAL CODES.

AREA OF LANDS: 0.0000 SQ. METERS.

AREA OF BUILDING: 10000.00 SQ. METERS.

AREA OF ROOF: 10000.00 SQ. METERS.

AREA OF TERRACE: 10000.00 SQ. METERS.

AREA OF BALCONY: 10000.00 SQ. METERS.

AREA OF STAIRCASE: 10000.00 SQ. METERS.

AREA OF LIFT SHAFT: 10000.00 SQ. METERS.

AREA OF SERVICE SHAFT: 10000.00 SQ. METERS.

AREA OF COMMON AREA: 10000.00 SQ. METERS.

AREA OF PARKING: 10000.00 SQ. METERS.

AREA OF DRIVEWAY: 10000.00 SQ. METERS.

AREA OF WALKWAY: 10000.00 SQ. METERS.

AREA OF FENCE: 10000.00 SQ. METERS.

AREA OF GARDEN: 10000.00 SQ. METERS.

AREA OF PLANTATION: 10000.00 SQ. METERS.

AREA OF WATER BODY: 10000.00 SQ. METERS.

AREA OF OTHER: 10000.00 SQ. METERS.

PROPOSED FIFTH FLOOR RESIDENTIAL BUILDING OVER EXISTING (G+4) RESIDENTIAL BUILDING FLOT NO. - 158(L.R.)

ADDRESS: 158, CHANDRA NAGAR, HOOGLY, WEST BENGAL UNDER ASAMBAUGH MUNICIPALITY

HOLDING NO. - 458M

P.S. - ASAMBAUGH DIST. - HOOGLY, WEST BENGAL UNDER ASAMBAUGH MUNICIPALITY

DATE: 15/04/2024

SCALE: 1:100

DATE	15/04/2024
SCALE	1:100
DATE	15/04/2024
SCALE	1:100
DATE	15/04/2024
SCALE	1:100

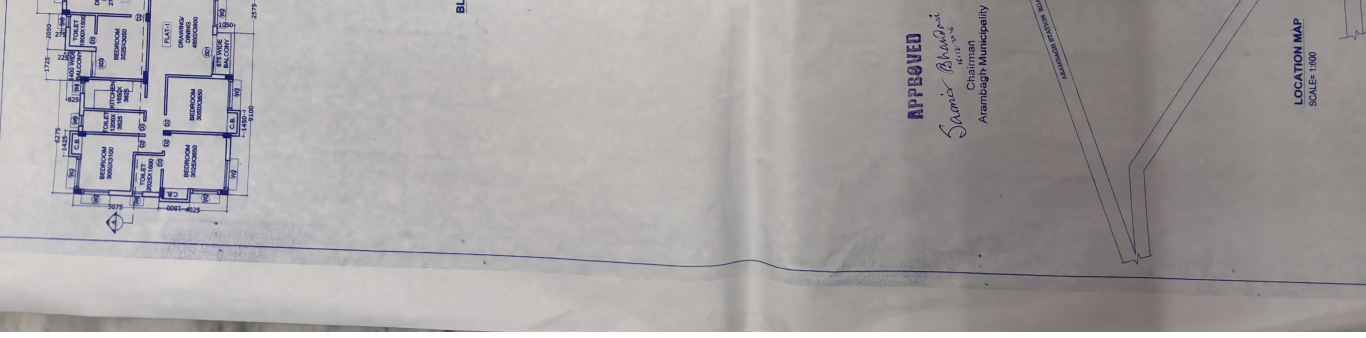

APPROVED

Saurabh Bhattacharya
Chartered Engineer
Asambugh Municipality

APPROVED

Saurabh Bhattacharya
Chartered Engineer
Asambugh Municipality